



Family owned and operated since 1904.

DESIGNED TO WORK | BUILT TO LAST

Mickey Truck Bodies is the nation's leading designer and manufacturer of all-aluminum roll-up door bodies for the automotive battery industry. If you don't see the exact model you need, contact us at **1-800-334-9061** so we can custom design and quote to your specific requirements.

* All capacities based on an average 40 lb. battery weight.

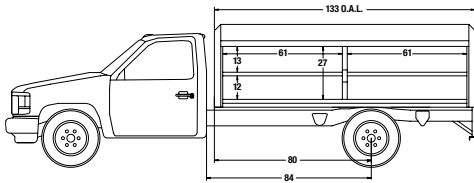

Four-Bay Mini for GMC/Chevrolet HD3500
Capacity: 127 batteries* **Access: side load**
GVW: 13,400 **Bays: 61"**

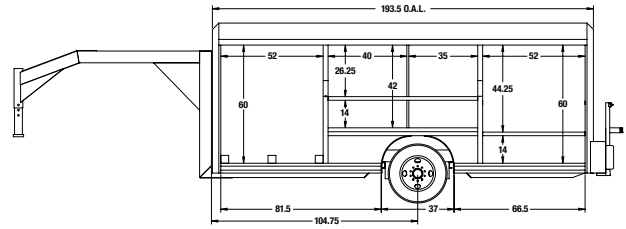

Gooseneck Trailer
Capacity: 180 batteries* **Access: side load**
GVW: 12,699 **Bays: 52", 40", 35", 52"**

THE UNITS BELOW FEATURE CHEVROLET LCF (LO CAB FORWARD) CONFIGURATIONS

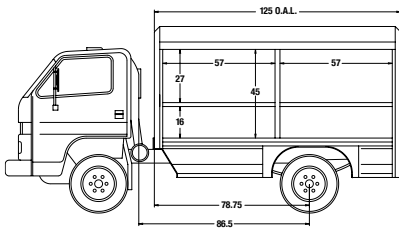

Chevrolet LCF Four-Bay Mini Cab-over
Capacity: 160 batteries* **Access: side load**
GVW: 13,500 - 15,500 **Bays: 57"**

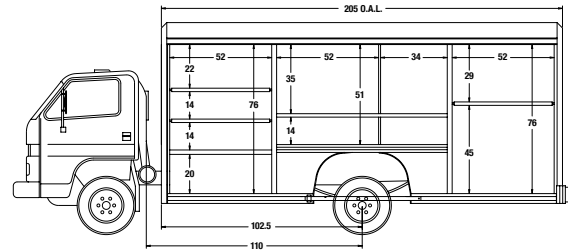

Chevrolet LCF Six-Bay Conv.
Capacity: 275 batteries* **Access: side load**
GVW: 25,900 - 28,000 **Bays: 52", 52", 34" plus bay, 52"**

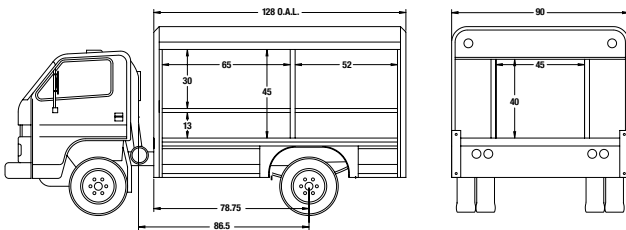

Chevrolet LCF Four-Bay Mini Rear Loader
(also available in cab-over version)
Capacity: 164 batteries* **Access: rear and side load**
GVW: 15,000 - 21,000 **Bays: 65", 52", 45" rear bay**

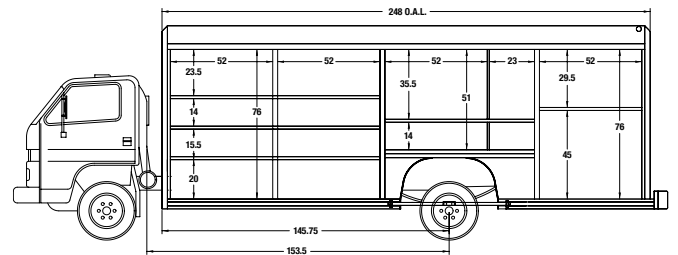

Chevrolet LCF Eight-Bay Conv.
Capacity: 405 batteries* **Access: side load**
GVW: 29,000 - 33,000 **Bays: 52", 52", 77.5", 52"**

Mickey Truck Bodies Inc
 Manufacturing & Corporate Office
 1305 Trinity Ave | PO Box 2044 | High Point, NC 27261

Toll Free: 800.334.9061 / Local: 336.882.6806 / Fax: 336.889.6712



Chevrolet LCF (Lo Cab Forward)

ACDelco Battery Body Specifications\Payload (EST.)

Style/Model	Door	Length	Batteries	C/A**	GVWR
4-bay Mini for GMC/Chevrolet HD3500	61W	133"	127*	84"	13,400
Chevrolet LCF 4-bay Mini C/O	57W	125"	160*	86.5"	13,500 - 15,500
Chevrolet LCF 4-bay Mini R/L	65w/52w 45w rear entry bay	128"	164*	86.5"	15,000 - 21,000
Gooseneck Trailer	52w/40w 35w/52w	193.5"	180*	102"	12,699
Chevrolet LCF 6-bay Conv. Plus	52W/52W 35w/52w	204"	275*	110"	25,500 - 29,000
Chevrolet LCF 8-bay Conv.	52W/52W 77.5w/52w	248"	405*	153.5"	29,000 - 33,000

* All capacities based on an average 40 lb. battery weight. | ** C/A is determined by chassis



2016 LCF Chevy chassis can be mounted with any of the Mickey bodies on this sheet.
For more details contact:
 Steve Mason
 smason@mickeybody.com
 336-210-6133



Parts and Service

Mickey Truck Bodies has long been recognized as the leading supplier of parts in terms of availability and service. We offer a large inventory of stock parts for same-day shipping on all orders received by 2 PM, and all fabricated parts are shipped within one to three working days.

Parts are available from our main manufacturing facility in High Point, NC as well as from any of our regional Reconditioning and Service Centers located throughout the country.

Any part that is received damaged, or is not the exact part ordered, will be replaced and shipped the day of notification at no charge, with no questions asked.

ACDelco Battery Body Standard Features

- Computer designed all aluminum construction
- Machine castings enhance strength and durability
- Most efficient working profile in the industry
- Integrated All-Weather Door Loc™ system
- Adjustable air vents installed in front bulkhead
- Battery coating on all bay walls, floors and shelves
- Plastic bay liners on walls, floors and shelves
- Reinforced shelves to accommodate batteries
- One-piece front and rear bulkhead skins
- Paint and apply decals to ACDelco specifications

