



Mickey Truck Bodies INC

Sideloader Operations, Parts & Options Manual





Designed to work. Built to last.

Table of Contents

MICKEY CORPORATE OVERVIEW 3

WARRANTY 4

OPERATION & MAINTENANCE

Product Safety Signs & Information Tags 6 -11

Pre-Operation Checks 12

Doors 13 - 18

Roof..... 19

Shelves 20

Wheel House Step Bars 21

Trailer Pull-Out Steps..... 22

Interior/Exterior Body Care..... 23, 24

Wiring..... 25

Running Gear & Suspension 26 - 28

Suspension Trouble Shooting..... 29, 30

PARTS

Standard Mickey Body Parts Illustration 32

Standard Mickey Trailer Parts Illustration 33

Parts..... 34 - 39

OPTIONS

Mini Side Load Bodies..... 41

Standard Side Load Bodies 42

Conventional Side Load Trailers 43

Bulk Units 44

Water Bodies 45

ProVend Vending Bodies 46

Full-Service Vending Body 47

E-LOCK 48

REGIONAL RECONDITIONING & SERVICE CENTERS 49

ORDERING REPLACEMENT & OPTIONAL PARTS..... 50





Designed to work. Built to last.

MICKEY CORPORATE OVERVIEW

Thank you for your confidence in our company, our products and our people.

Mickey Truck Bodies was founded in 1904, and we have always been privately owned and operated by the Mickey family. Three members of the Mickey family are active in the day-to-day running of the company, including the President/CEO; Executive Vice President; and VP of Manufacturing.

Mickey Truck Bodies is the most versatile manufacturer of specialized truck bodies and trailers in the world, with a customer base that reads like a "who's who among global brands." Leading companies across dozens of industries, including beverage, furniture, emergency services, home improvement, snack foods, battery distribution and oil & gas, deliver their products in Mickey bodies and trailers. All told, the company builds thousands of units a year for customers in over 50 countries around the world. The company continuously invests in automating its manufacturing facilities and processes to produce the most technologically-advanced bodies and trailers in the world.

One of the main factors behind Mickey's tremendous growth over the past several years has been its unwavering commitment to after-sales customer service and support. The company offers a large inventory of stock parts that are shipped the same day if ordered by 2 P.M., and all fabricated parts are shipped within one to three working days. Any part that is received damaged, or is not the exact part ordered, will be replaced and shipped the day of notification at no charge, with no questions asked.

Mickey also owns and operates full-service regional Reconditioning /Service Centers located in key markets throughout the U.S. These Centers provide major overhauls as well as minor cosmetic repairs for all Mickey products as and competitive units. We handle every reconditioning and repair job separately and uniquely according to the specific needs of our customer.

When you bought your sideload body and/or trailer from Mickey, it was just the beginning of what we trust will be a very long and mutually prosperous relationship. To help establish and develop that relationship, we intend to stand behind the product we sold you. That is part of Mickey's commitment to excellence.

This document was developed as a user-friendly guideline for identifying and ordering the parts or options for your Mickey sideload body and/or trailer. We take great pride in offering our customers custom-designed equipment, features and options. If you need any help beyond the information provided in this manual, please call us at our toll-free number 800-334-9061 and we'll be happy to help you in any way that we can.

Again, thank you for your business and your confidence. Please drive safely.

Dean Sink

A handwritten signature in blue ink that reads 'H. Dean Sink'.

Mickey President

NOTE: Click on any URL or email address in this document and you will be taken to that location.



Designed to work. Built to last.

TWELVE (12) YEAR EXCLUSIVE LIMITED WARRANTY FOR SIDE-LOADING BODIES AND TRAILERS

Mickey Truck Bodies Inc. ("Mickey") warrants that each side-loading style truck body, each truck chassis alteration incident to construction and installation of a side-loading style truck body, and side-loading style trailer (hereinafter collectively referred to as a "Side-Loading Body") shall be free from defects in design, workmanship and materials, when used in normal commercial service and when properly maintained in accordance with Mickey standards, for a period of twelve (12) years from the date of delivery of the Side-Loading Body, subject to the following conditions, restrictions and limitations:

Mickey hereby warrants all paint, finishes, decals, pre-painted sheets, flooring, electrical components, lights, wiring, doors, door locking devices, plastic components, rubber parts, and alteration of the drive shaft of any truck incident to the construction and installation of a Side-Loading Body, for a period of only one (1) year following delivery of the Side-Loading Body, subject to the conditions, restrictions and limitations contained herein.

This Exclusive Limited Warranty shall not apply to: (1) defects in the design, workmanship or materials of the vehicle chassis except that, in the event and solely to the extent that Mickey has in any way modified or altered the vehicle chassis in constructing and installing the Side-Loading Body, this limitation shall not apply with respect to any such modification or alteration; (2) defects arising out of deterioration of any aspect of the Side-Loading Body due to normal wear and tear and exposure to the elements; (3) defects in the design, workmanship and materials of products separately manufactured and not designed and constructed by Mickey, but which are merely assembled or installed by Mickey on the Side-Loading Body, including, but not limited to, component parts and accessories such as tires, brakes, axles, springs, wheels, landing gear, suspension systems, running gear, bayliner material, and other accessories required by the purchaser; and (4) any tractor supplied by Mickey at the purchaser's request in connection with the purchase of a tractor/trailer style Side-Loading Body. To the extent a manufacturer or supplier of the tractor, vehicle chassis and other component parts assembled or installed by Mickey on the Side-Loading Body has provided warranties to Mickey, Mickey agrees to assign said warranties to the original purchaser of the Side-Loading Body. In no event shall Mickey be deemed to have joined in the warranty assigned or, by such assignment, to have made any separate warranty apart from that which is contained in this Exclusive Limited Warranty, and Mickey does not warrant that the tractor, vehicle chassis or any such component part meets the conditions of any assigned manufacturers' or suppliers' warranties.

This Exclusive Limited Warranty shall be void with respect to any particular Side-Loading Body if (a) the total weight of the Side-Loading Body and its cargo at any time exceeds the Gross Vehicle Weight Rating ("GVWR") established by the chassis manufacturer and specified on the vehicle identification plate affixed to the vehicle by the chassis manufacturer prior to delivery; (b) the load weight of any axle on the Side-Loading Body at any time exceeds the Gross Axle Weight Rating ("GAWR") established by the chassis manufacturer and specified on the vehicle identification plate affixed to the vehicle by the chassis manufacturer; (c) the Side-Loading Body is at any time damaged in a collision or other accident, damaged as a result of abuse, misuse, or neglect in any manner (including use of loading equipment), or unlawful operation of the Side-Loading Body or vehicle on which it was installed; (d) the Side-Loading Body is damaged by corrosive, hazardous or inherently unsafe or dangerous materials or chemicals; (e) the Side-Loading Body is not maintained in accordance with Mickey's published maintenance schedule; or (f) the Side-Loading Body is repaired, altered or modified in any respect by other than a Mickey-authorized service center or service technician unless such repairs, alterations and modifications are specifically authorized, in writing, by Mickey engineering or service personnel. Under no circumstances are Mickey sales personnel authorized to approve or authorize repairs, alterations or modifications to a Side-Loading Body.

This Exclusive Limited Warranty shall be void with respect to any particular defect on any particular Side-Loading Body unless Mickey shall be informed, in writing, of the existence of the claimed defect within the shorter of (1) thirty days after the discovery of the defect or (2) such shorter time that is necessary to effect repair or replacement of the defect in order to avoid aggravation or worsening of the existing defect or the creation of additional damage. This Exclusive Limited Warranty shall not apply to (1) any defect which was caused or created by a prior existing known defect or (2) any aggravation or worsening of an existing known defect, which could have been avoided by timely and reasonable attention and repair or replacement of such existing defect.

THIS WARRANTY IS MADE BY MICKEY SOLELY TO THE ORIGINAL PURCHASER OF THE SIDE-LOADING BODY AND IS EXPRESSLY GIVEN IN LIEU OF ANY AND ALL OTHER WARRANTIES EXPRESS OR IMPLIED. MICKEY EXPRESSLY DISCLAIMS AND MAKES NO IMPLIED WARRANTY OF MERCHANTABILITY AND NO IMPLIED WARRANTY OF FITNESS FOR A PARTICULAR PURPOSE.

The sole and exclusive remedy for any defect covered by this warranty shall be limited to the repair or replacement of such Side-Loading Body, or warranted component thereof, at Mickey's option; provided that, Mickey shall not be liable, in repair or replacement of a Side-Loading Body, for an amount greater than the Prorata Value of the Side-Loading Body. The "Prorata Value" shall be calculated by multiplying the sale price of the Side-Loading Body by a fraction, the numerator of which is the remaining term of the warranty applicable to the defect, as of the date of notification of the defect to Mickey, and the denominator of which is the full term of said warranty.

MICKEY SHALL NOT BE RESPONSIBLE OR OTHERWISE HELD LIABLE FOR ANY INCIDENTAL, CONSEQUENTIAL, OR SPECIAL DAMAGES RESULTING FROM ANY CLAIM RELATED TO A SIDE-LOADING BODY AND DEFECTS COVERED BY THIS EXCLUSIVE LIMITED WARRANTY, INCLUDING, BUT NOT LIMITED TO, CARGO LOSS, LOSS OF USE, PROPERTY DAMAGE, PERSONAL BODILY INJURY (INCLUDING DEATH) OR OTHER COMMERCIAL OR ECONOMIC USE.

This Exclusive Limited Warranty provides the sole and exclusive warranty to the exclusion of all oral statements or other writings made by Mickey or its agents. No other warranties or affirmations made outside this written warranty shall be effective. This Exclusive Limited Warranty is not transferable by the original purchaser.

Buyer shall contact the "Customer Service department" of Mickey Truck Bodies, Inc., Post Office Box 2044, High Point, North Carolina 27261, Telephone (336) 882-6806, for authorization for correction of all deficiencies covered by this warranty.



Designed to work. Built to last.

OPERATION & MAINTENANCE



Designed to work. Built to last.

OPERATION & MAINTENANCE - PRODUCT SAFETY SIGNS & INFORMATION TAGS

Your new Mickey Body is equipped with Caution Signs and Unit Designations in all appropriate places. Please become familiar with these tags. (If these tags are removed or become damaged, Mickey Truck Bodies will replace at no charge.)

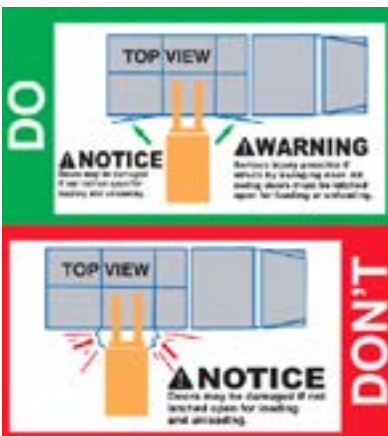

OPERATION & MAINTENANCE - PRODUCT SAFETY SIGNS & INFORMATION TAGS



(OPTIONAL INFORMATION) Location:
Below landing gear crank



Location: Inside cab door jam drivers side



OPERATION & MAINTENANCE - PRODUCT SAFETY SIGNS & INFORMATION TAGS

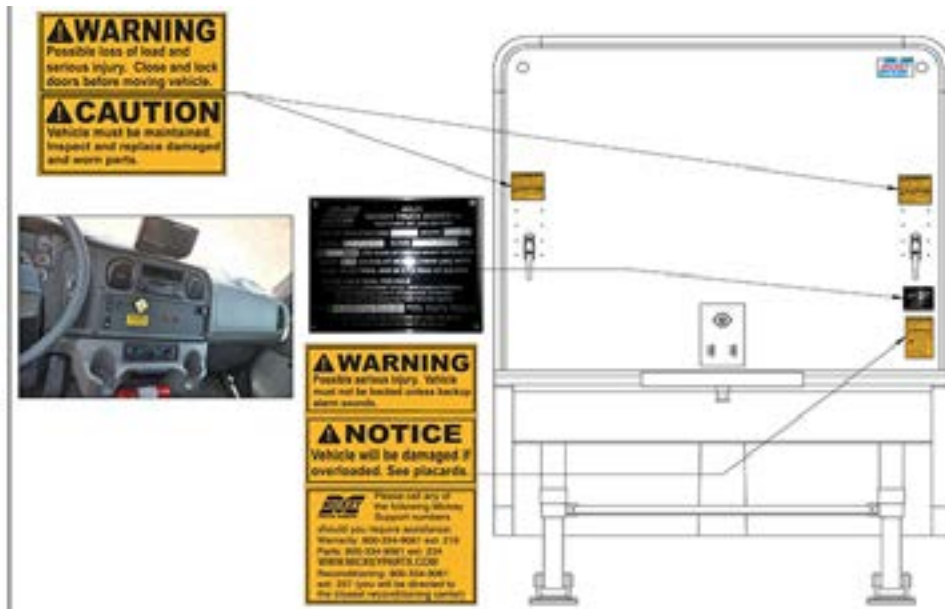
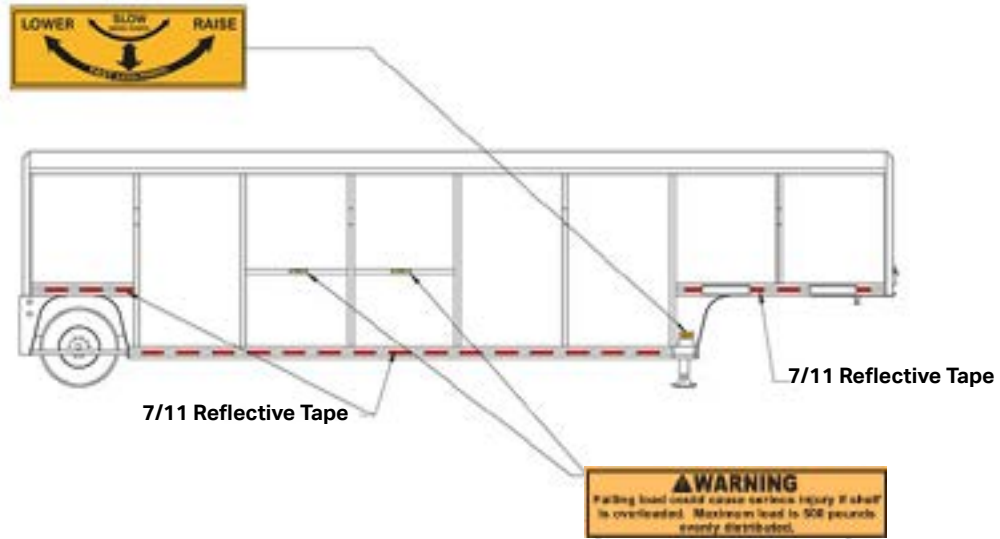

OPERATION & MAINTENANCE - PRODUCT SAFETY SIGNS & INFORMATION TAGS

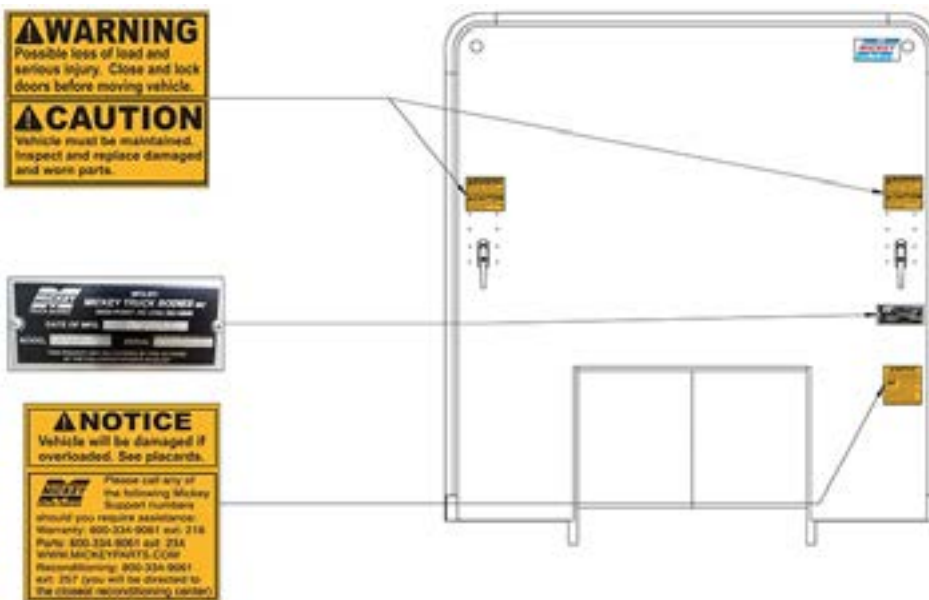
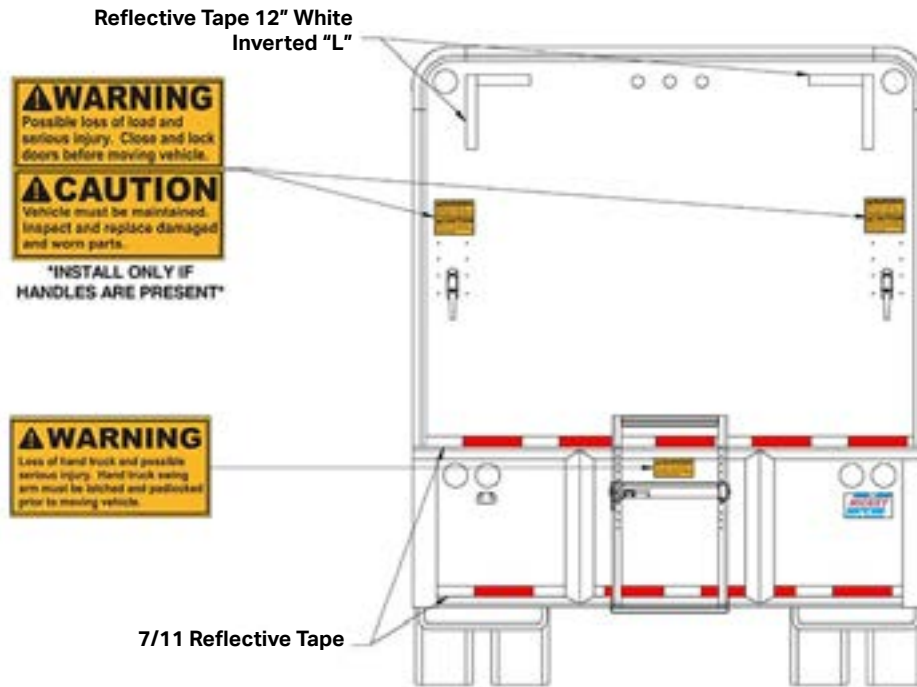

OPERATION & MAINTENANCE - PRODUCT SAFETY SIGNS & INFORMATION TAGS

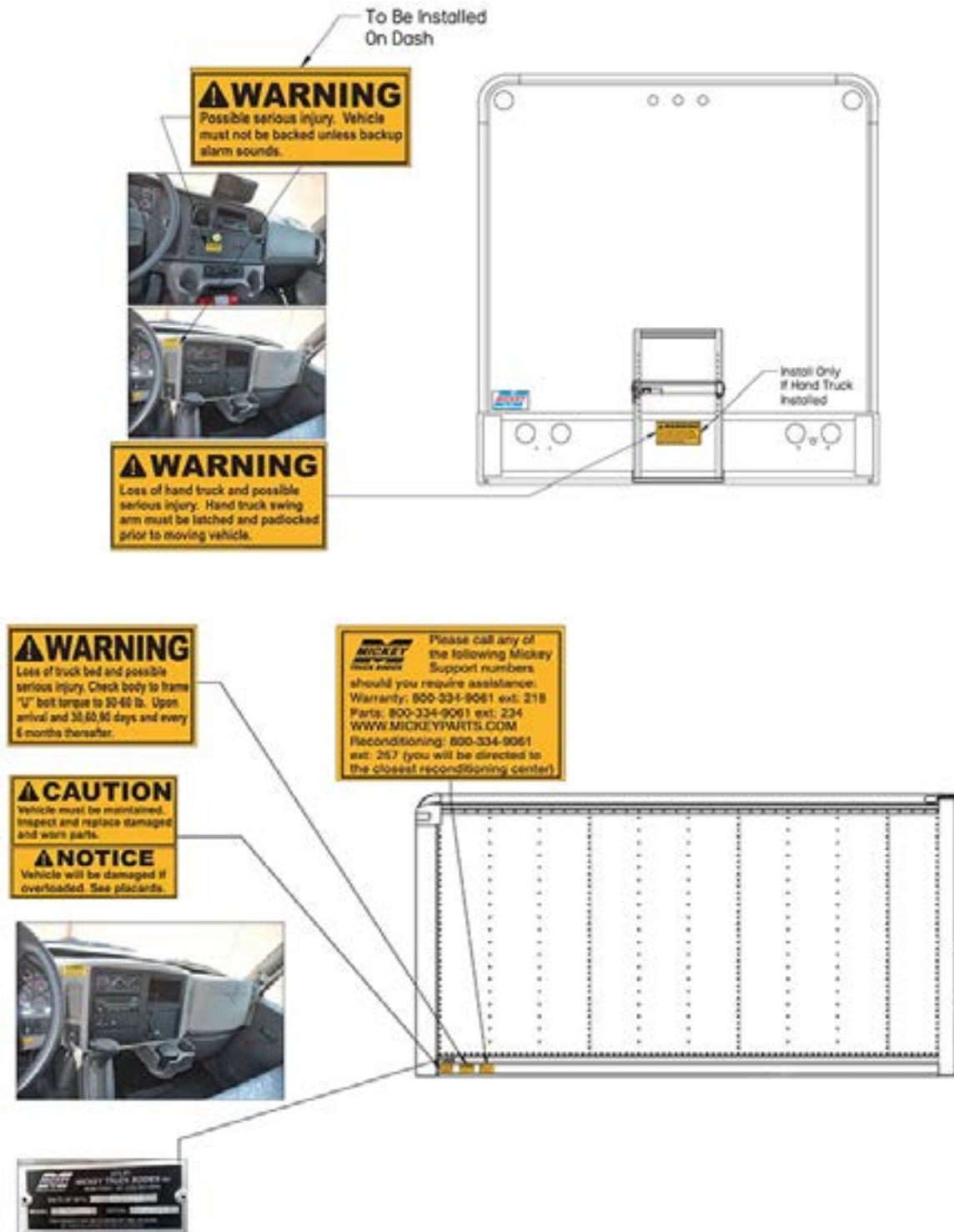

OPERATION & MAINTENANCE - PRODUCT SAFETY SIGNS & INFORMATION TAGS

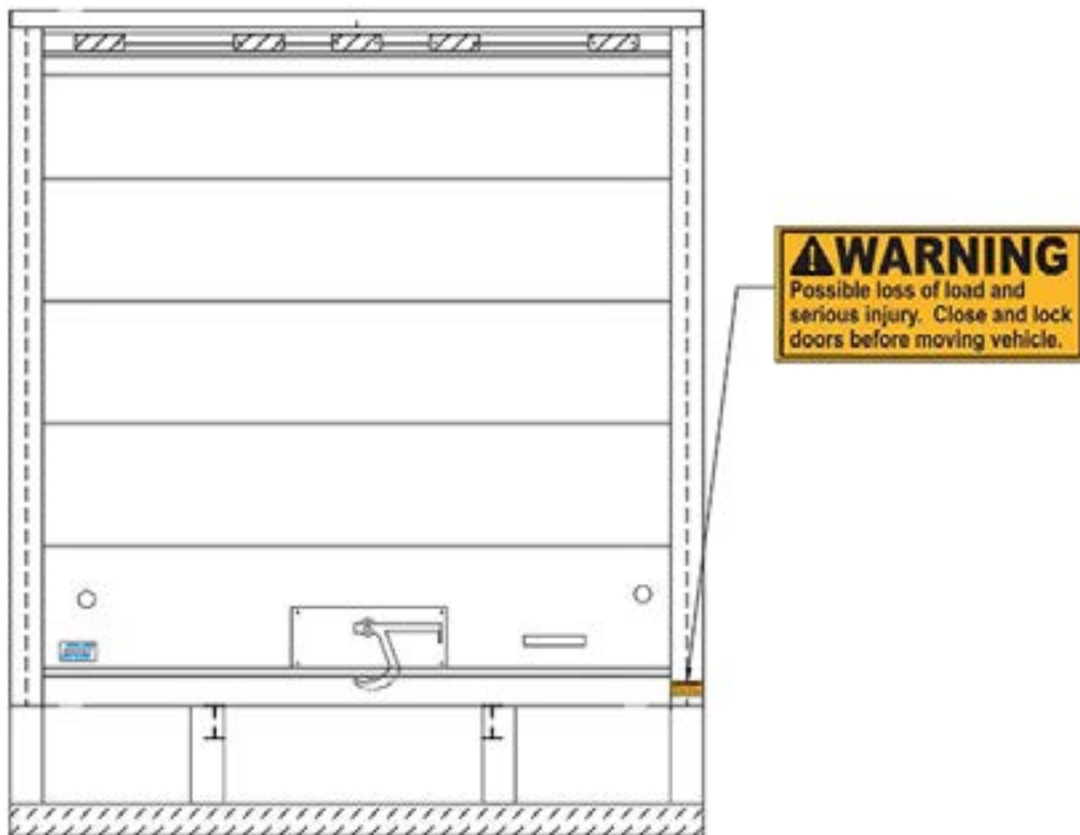
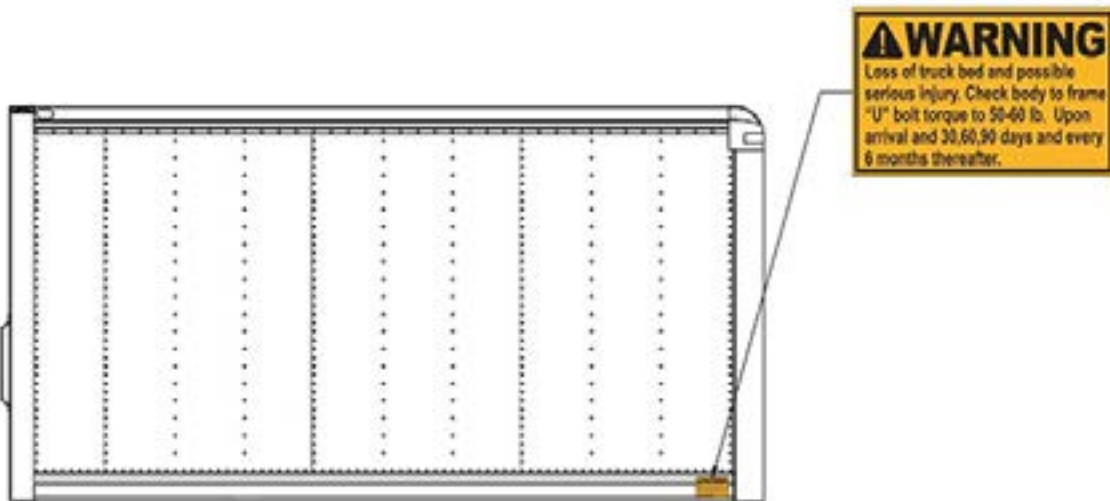

OPERATION & MAINTENANCE - PRE-OPERATIONAL CHECKS

Pre-Operational Checks:

- Check lights for proper operation.
- Check brakes for proper operation.
- Check all door locks before operating the unit by pulling the doors down, engaging the locks and then trying to roll up the doors. If the doors move up even slightly, you may need to adjust the locking system (see Door Lock System Adjustment, PAGE 15 for details).
- Conduct a visual inspection of the body/chassis points of attachment on a regular basis. These points occur in the front of the unit directly behind the cab (spring mounts), and before and after the wheel wells (rigid mounts). If you notice any "abnormal" connections, consult the manual provided by your chassis supplier and/or contact Mickey Customer Service at 800-334-9061.
- Inspect pull-out steps for damage and fractures. Be sure that the tread surface is clean. Always return step to the stored position prior to operation of vehicle to avoid damage. (Photo right)
- Make sure the bar steps are not pushed against the tire, causing friction damage. Be sure that the attaching pin and bracket are in tact and have not been damaged. On a spring-type step, be sure that the spring can be compressed and is able to move freely. (Photo below)



- Inspect hand truck racks for damage and proper attachment to the bumper. Inspect the rubber "bungy" cord for wear and deterioration.
- For ease of operation, the spring-loaded locking pins on the bay shelves should be lubricated with Liqui Fix or a similar lubricant.
- Check that all grab handles have not been dislodged or damaged during loading and unloading of product. If they have been damaged, they must be replaced.



Front Hand Truck Rack



Rear Hand Truck Rack



Designed to work. Built to last.

OPERATION & MAINTENANCE - Doors

Your Mickey unit was designed for easy maintenance and repair when necessary. Most of the parts for these units are door or door locking systems.

OPERATION:

- Never operate your vehicle with the doors in an unlocked position. Failure to comply with this requirement may result in product falling out of the vehicle during operation.
- The door strap should always be stored inside the body during vehicle operation in order to prevent damage to the exterior paint surface.
- Operation of the vehicle with the door in the closed and locked positions decreases the wear on the door rollers and door tracks.
- Keep door tracks clean from dirt and grease, which can inhibit the door's proper operation and cause premature door roller wear.



MAINTENANCE:

Should lubrication be required, it is strongly recommended that only a dry, high viscosity silicon lubricant—such as Liqui Fix—be used. Liqui Fix creates a long-lasting, clear, odorless corrosion-resistant barrier. Safe for all metals, plastics and today's synthetics fabrics and materials. Non-Toxic. Liqui Fix is available from the Mickey Parts Department at 800-334-9061 or online. http://www.mickeyparts.com/Liqui_Fix_Multi_Purpose_Lubricant_p/6009162.htm



Roll-Up Doors

The roll-up doors in your Mickey body are made up of many individual extruded aluminum door panels, or slats. The doors consist of a handle panel, intermediate (flat) panels (3" wide, and 5" wide), and a top panel. This system makes it easy to replace a damaged door panel without the expense of replacing an entire door. Specially-designed "drive-in" style door rollers maintain the alignment of the door panels and allow for easy opening and closing of the roll-up door. These rollers assure that the decals on your body remain straight and attractive while the unit is in operation.

OPERATION & MAINTENANCE - Doors

Door Panel Replacement

Remove the track "take-out" section of the exterior track post, raise the door and bring it back out through the "take-out" section. (A Torx #3 drive is required to remove the 4 screws from the track take-out section.) With a hammer, tap out the rollers connecting the panels, slide the extruded panels apart, put the new panel in place and tap the rollers back into the connected panels. (Be careful not to scratch or damage the door while it is outside of the body.)

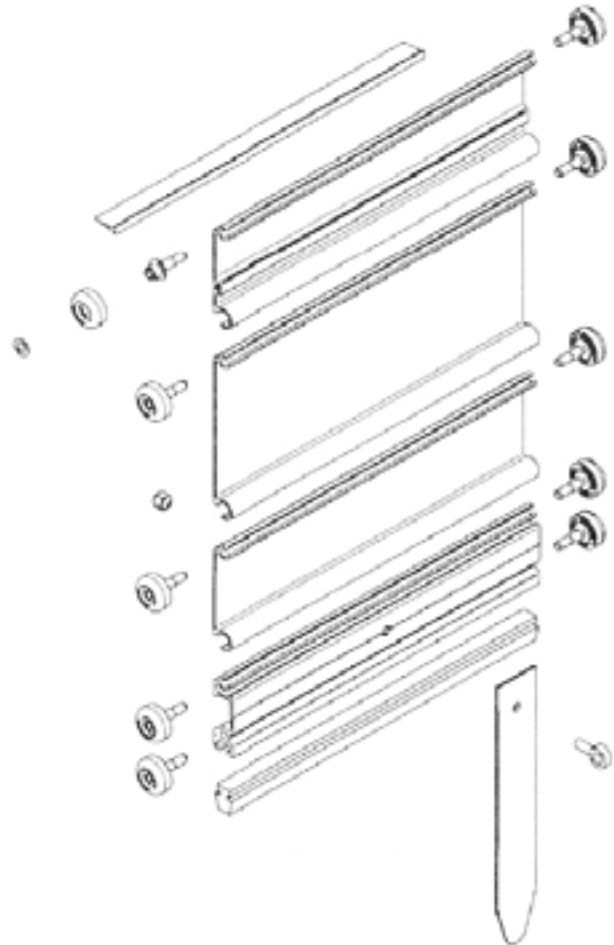
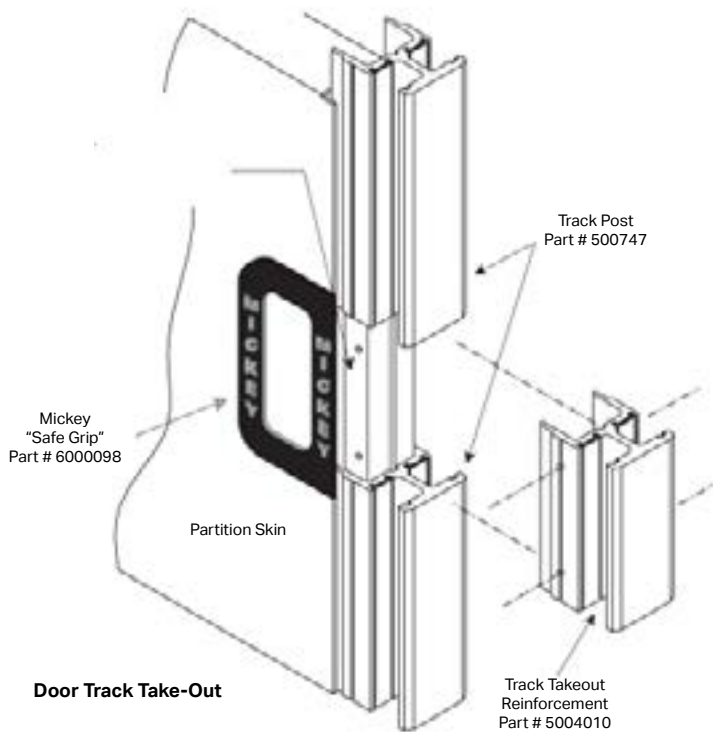

ATTENTION
DOOR ROLLERS AND DOOR STRAPS
MUST BE CHECKED ON A REGULAR
BASIS. DAMAGED OR FRAYED
STRAPS MUST BE REPLACED.

OPERATION & MAINTENANCE - Doors

Locks

Mickey's unique all-weather Door Loc is recognized as the industry's best locking system. The adjustable locking flap runs the entire length of the body and remains in full contact with the doors. It eliminates door scratching and vibration, thereby reducing door and track wear. (See Figure 01)

Door Lock System Adjustment

To adjust the tightness of your door lock system, remove the inspection plate on the inside of the door behind the lock handle, exposing the locking rod, locking rod extension, spring and nuts. Loosen the top nut, tighten the bottom nut, move the bar down until the desired tightness is achieved and then tighten the top nut.

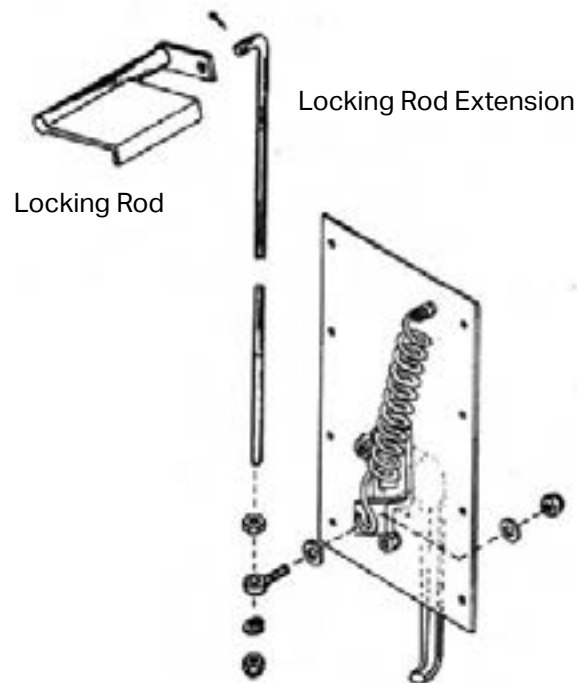

OPERATION & MAINTENANCE - Doors

Door Operator (counter-balance) Adjustment

If you notice your doors are becoming "heavy" during the opening operation, you can easily adjust the Door Operator System. Raise the door and hold it in place with a clamp or a pair of vice grips. (Put a piece of cardboard between the clamp and the unit to avoid scratching the paint.) Disconnect the "S" hook from the bottom of the door, pull down the cable to "load" or tighten the spring inside the counter-balance, then wrap the cable around the tube and connect the "S" hook back to the bottom of the door. Test the door operation and repeat the above instructions for further adjustments. (See figure 03)

The counter-balances are shipped from the factory with 12 "turns." You should not put in more than four additional turns. **CAUTION:** The counter-balance is under tension from the winding. Please use safety glasses when adjusting.

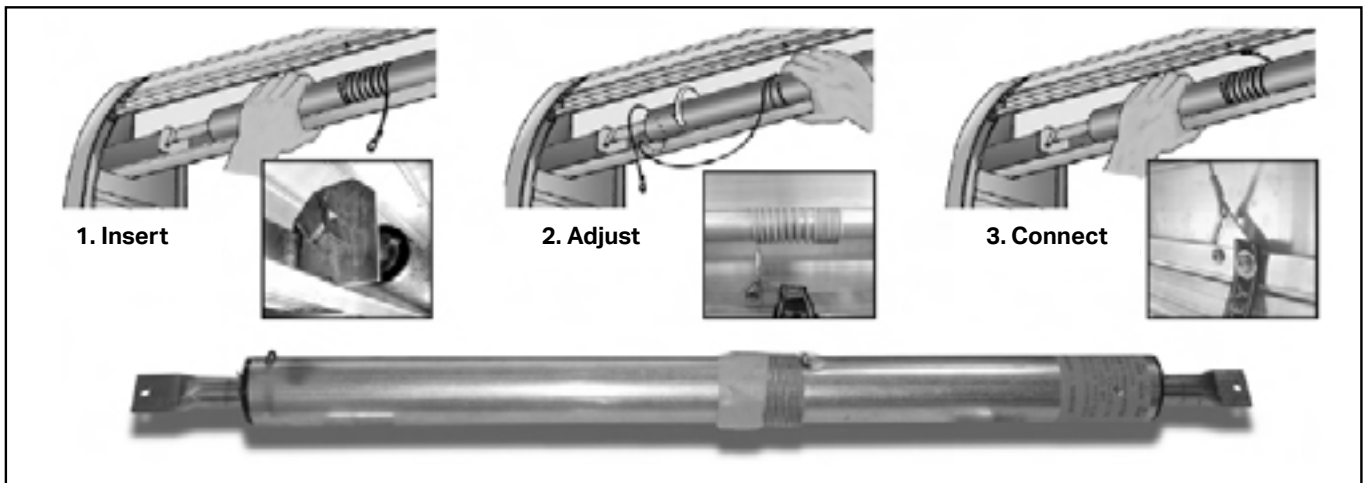

Door Rollers



OPERATION & MAINTENANCE - Doors

Lock Cylinder Replacement

To remove cylinder:

1. Push in lock cylinder until 3/16" of cylinder is showing outside locking handle.
2. While holding the cylinder at this 3/16" position, turn the key hard to the left (counter-clockwise). Cylinder should snap allowing spring to push cylinder out into hand.

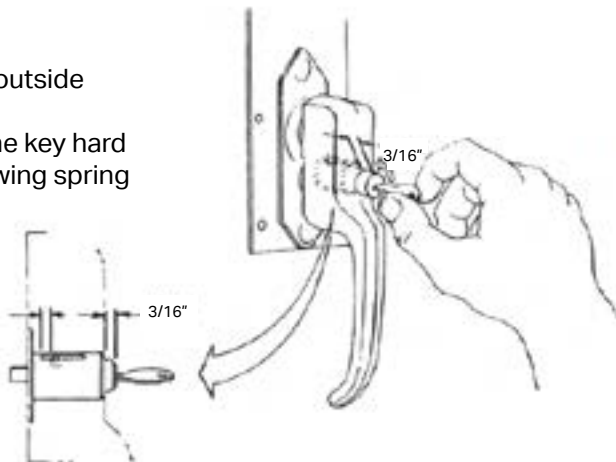

To install cylinder:

1. Be sure that the spring is in position inside cylinder barrel.
2. With cylinder turned to the extreme right (clockwise), align lobe on cylinder with smaller slot in cylinder barrel.
3. Push cylinder into barrel until 3/16" shows outside barrel.
4. While holding this 3/16" position, turn key hard to the right (clockwise). Cylinder should snap to the right, locking into position.

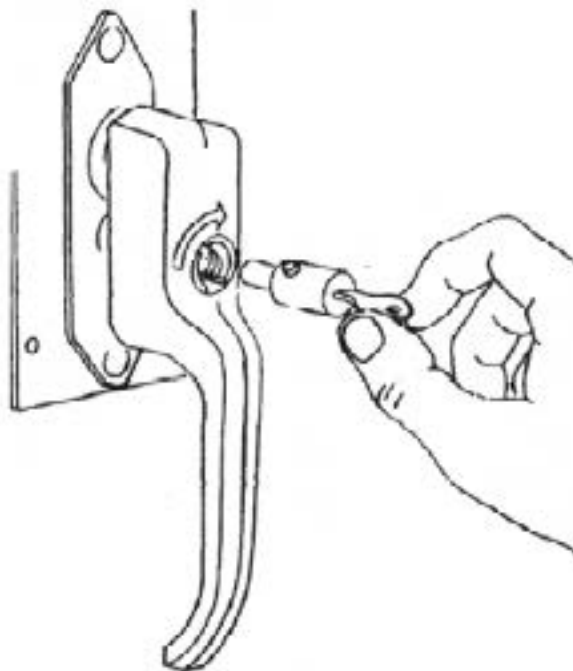

Key Lock
#6100965 DRIVER SIDE
#6101761 PASSENGER SIDE



Pad Lock
#6101763 DRIVER SIDE
#6101762 PASSENGER SIDE

OPERATION & MAINTENANCE - DOORS

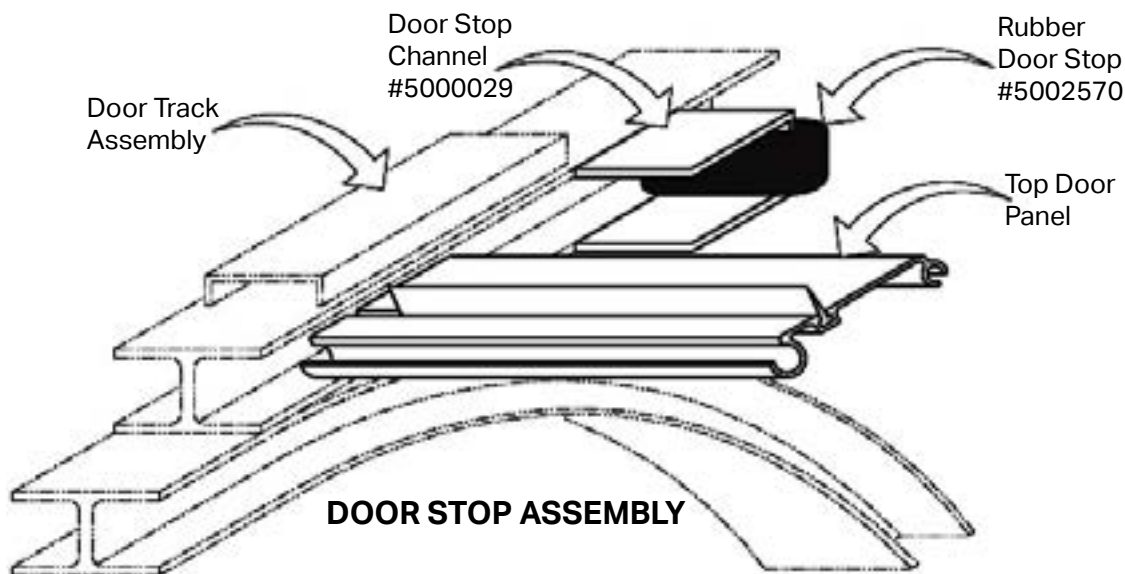

TRACK LINER & WEATHER SEAL INSTALLATION

OPERATION:

1. Liner and weather seal also fits corner posts. (Part #5000598)
2. Track liner snaps into post. Stake liner in place at the top of the post.

MAINTENANCE:

Keep door tracks clean from dirt and grease, which can inhibit the door's proper operation and cause premature door roller wear.



TRACK LINER
(1989 - 12/31/90)
Part #6100617



3-SIDED TRACK LINER
(2013 - CURRENT)
Part #s:
6104737 - 87.50"
6104738 - 56.50"
6104739 - 81.50"
6104740 - 120.50"

OPERATION & MAINTENANCE - ROOF

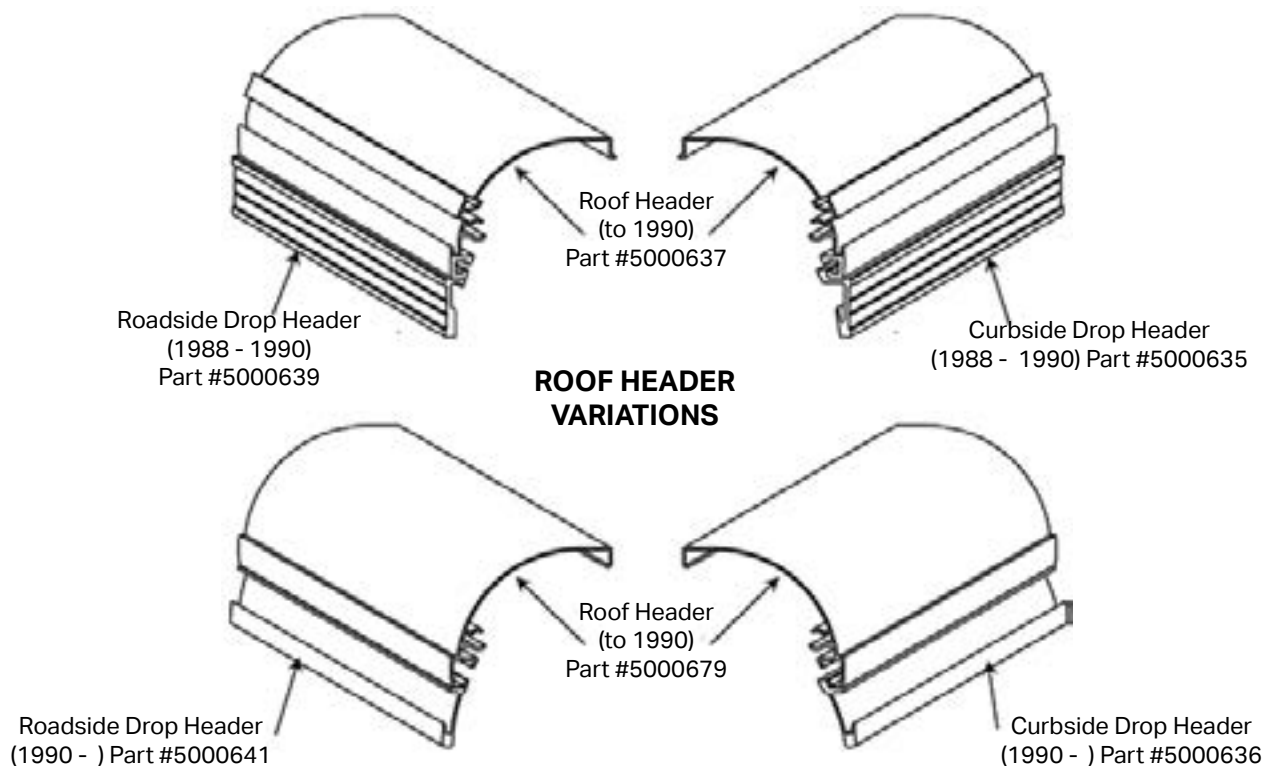
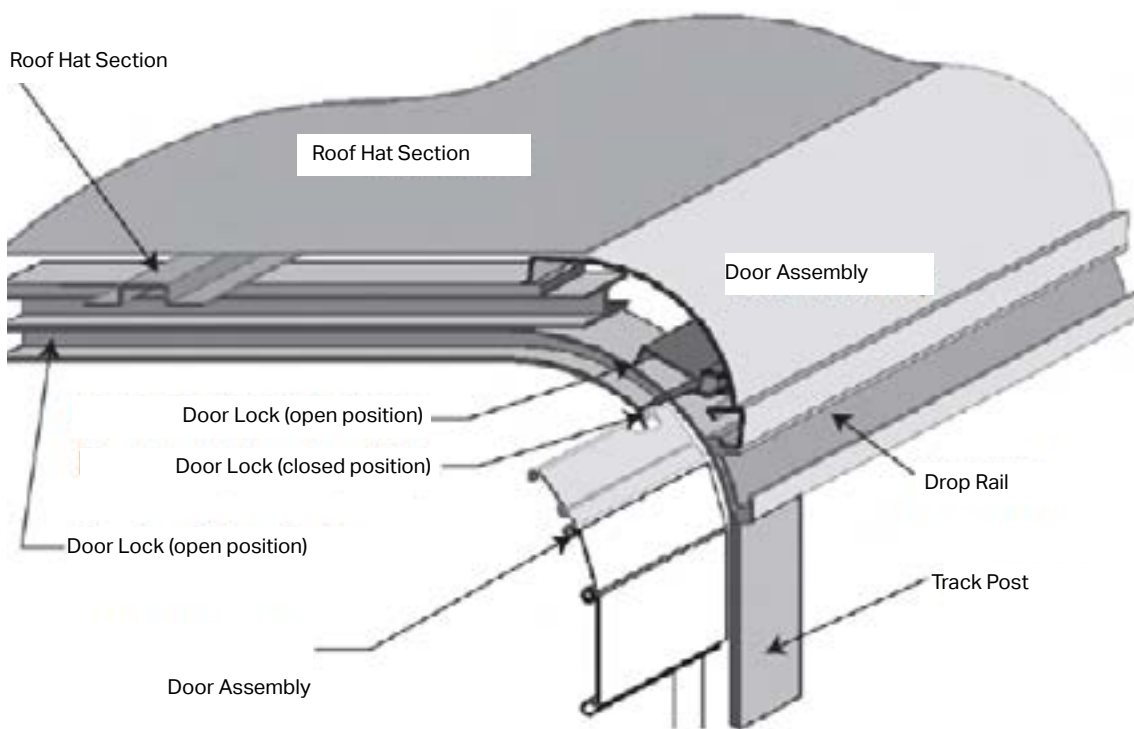

OPERATION & MAINTENANCE - SHELVING

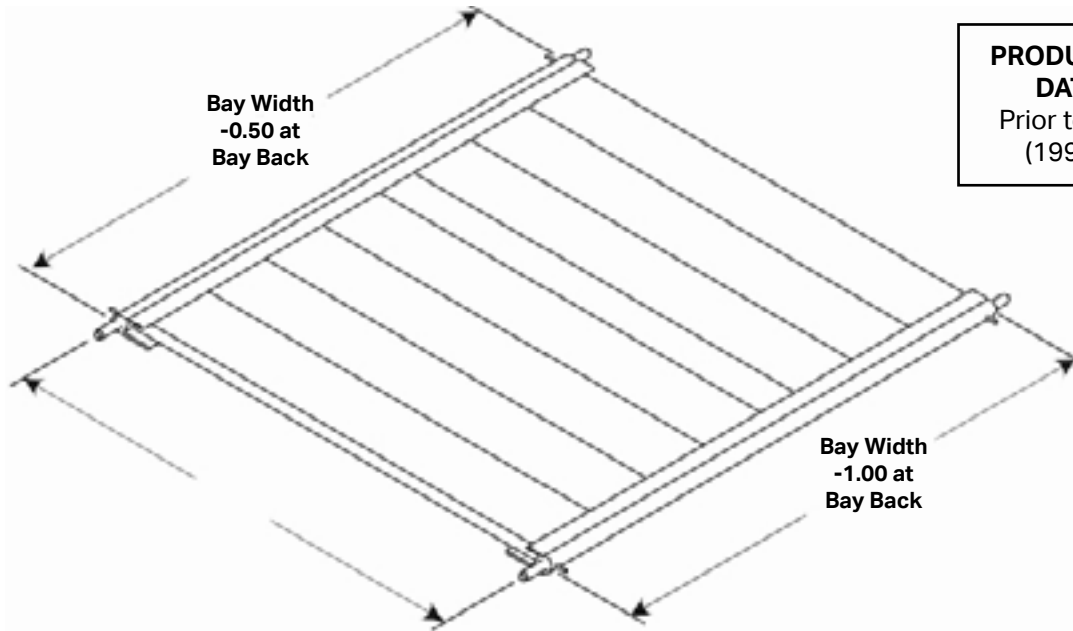

PRODUCTION DATES	DIM. "A" PIN SETTING
Prior to 1991	34.125"
(1991 -)	37.125"

SHELF ASSEMBLY
PART #4954145 (40")
PART #4954155 (52")

PIPE INSTALLATION DETAIL

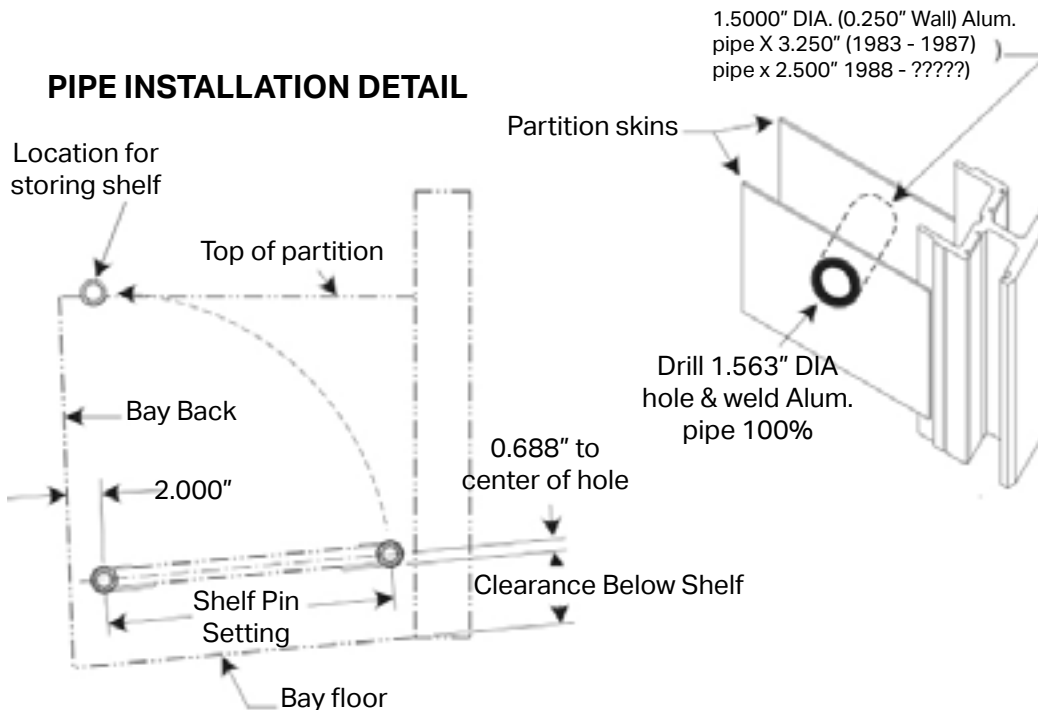

Operation:

1. Determine the clearance required below shelf, add 0.6888" for pin location and measure up from the floor.
2. Install aluminum pipe, as shown so that the shelf is parallel to the floor

OPERATION & MAINTENANCE - WHEEL HOUSE STEP BARS



Lynch Ring
5002720

Weld on Pin
6800980

Bolt-On Lynch Pin
5002710

General Socket Assembly
5002690

OPERATION & MAINTENANCE - TRAILER PULL-OUT STEPS

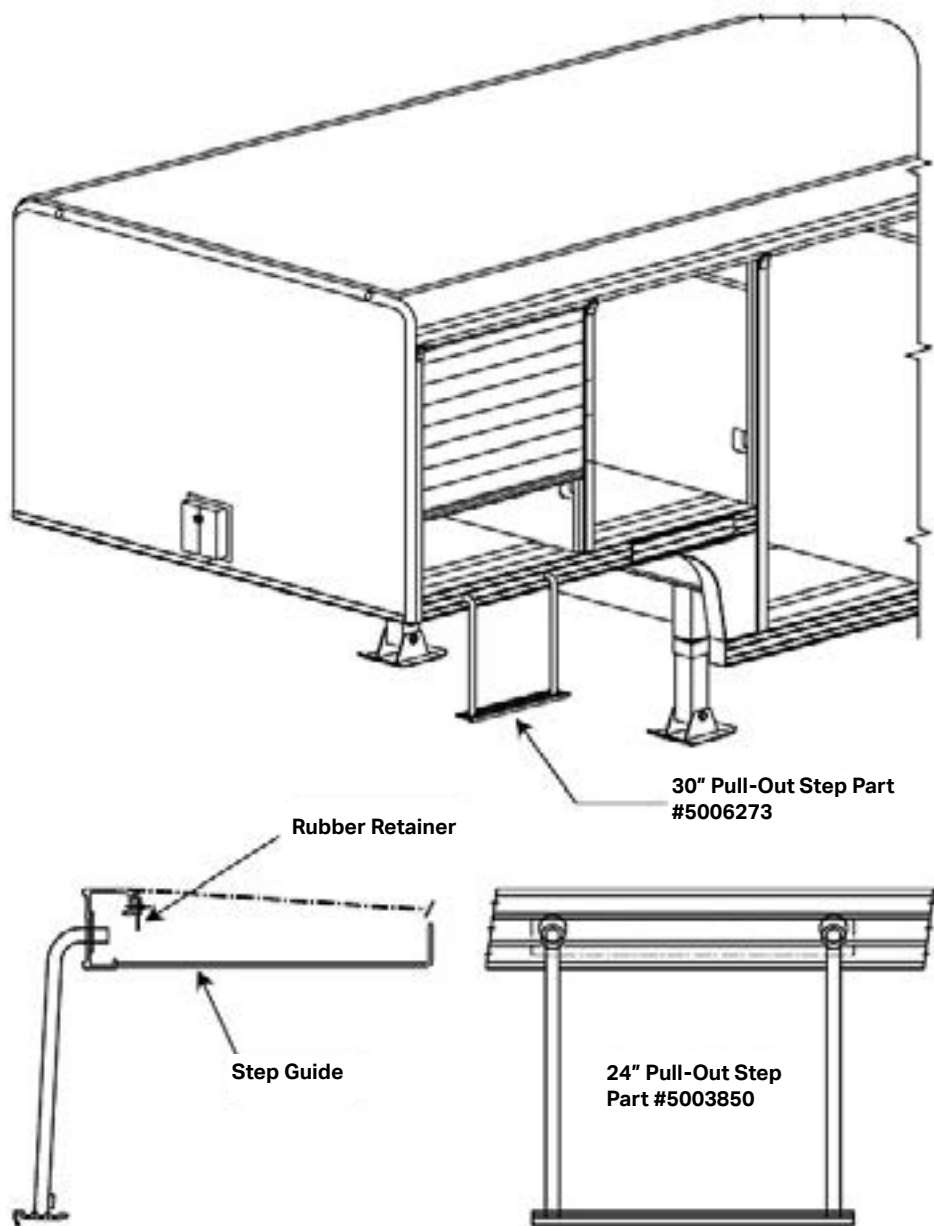

OPERATION & MAINTENANCE - INTERIOR/EXTERIOR BODY CARE

Your new Mickey sideloader has been built with the finest engineering and design capabilities, materials and workmanship. With the proper care, it should provide you with the best possible means of delivering your product to your customers for years to come. By properly maintaining your vehicle, you also preserve its appearance and appeal as a full-color "rolling billboard" for promoting your brands.

MAINTENANCE

Interior of the unit

Once a week the unit should be emptied and the interior should be thoroughly washed out with clean water, with particular attention paid to the bottom back of the bays where dirt and trash can accumulate. Dirt will absorb liquids, which could create odors and other problems. Mickey units are designed with bay "drain holes, which should also be kept clean and free from accumulated dirt and trash.

The special polyethylene bay-back liners (right) are designed to protect product from discoloration and abrasion. These liners should be kept clean and checked routinely for rips and tears to ensure delivery of the most desirable product possible.

During the weekly washing procedure, look carefully for any structural cracks in all of the obvious connections—between walls and floors; walls and ceilings; at weld points; etc. If you find a crack, contact the Mickey Customer Service Department at 800-334-9061.

Check door for proper operation. If door moves, or "shimmies," in or out during roll-up or roll-down, check door rollers for excessive and/or improper wear. Also check for track liner damage. When checking for door roller wear, remember that the roller wears out from the inside at the point where the roller connects to the shaft, or axle pin.



Interior of the unit

Frequent washings of the Truck Body or Trailer are required to remove contaminants that can stain and oxidize and accelerate corrosion. It is especially important to wash the vehicle regularly during the winter months. Wash the vehicle as soon as possible after contact with road salt. Waxing offers added protection, but allow at least 60 days after date of manufacture for initial application.

- Do not use any solution that can damage the paint.
- Most chemicals require dilution.
- Any vehicle is subject to deterioration from industrial fumes, ice, snow, corrosive road salt, etc., to name just a few causes. Regular and correct care will contribute to maintaining the beauty and the value of your vehicle.

OPERATION & MAINTENANCE - INTERIOR/EXTERIOR BODY CARE (continued)

1st 90 Days:

- Do not wax or polish the vehicle – this will allow the finish to dry and harden completely.
- Do not use silicone containing waxes or polishes either.

General rules for winter maintenance

- INCREASE the frequency of washing your equipment: Traveling highways treated for winter weather can leave residue on your equipment that is very harmful. Make sure to take your truck through a wash station at least once a week to clean off harmful residue, and be sure to clean the bottom of your truck as well.
- NEVER scrape off ice or snow: Ice scrapers or extremely coarse brushes can scratch and chip the finish of your equipment. Use caution when removing ice or snow from coated areas of the equipment.

Decals

In general, once your decals have been properly installed by a professional decal installer, they will hold up against harsh weather conditions. However, in order to keep the decals adhered properly and the color imprints vivid, take these steps:

- Immediately following an ice and/or snow storm and whenever practical, wash the vehicles to remove all the chemicals associated with clearing the streets and highways that collect on the unit. Do not allow the vehicles to sit long periods of time with ice, snow and road chemicals on them without washing them. This is true particularly for units with full wraps.
- Do not use heat to remove ice and/or snow from the decaled areas of the unit. This could damage the decals underneath.
- Scrap ice and/or snow only from the glass surfaces on the unit.

The vinyl and laminate used to print and fabricate the decals applied on Mickey bodies and trailers are manufactured to withstand the elements, including hot and cold temperatures and severe winter weather. Overall, it just takes common sense and a customer's pride in maintaining a good-looking fleet in winter conditions to insure the decals continue to perform and visually display the brand/message on each unit for a long time.

Paint Touch Up

Small areas that become scratched from time to time in normal service can be easily touched up with a small paint brush to help keep your unit looking new. The standard paint colors are available from Mickey's Parts Department at 800-334-9061. With your new all-aluminum body or trailer, rust is not a problem!

Repair paint chips immediately.



Mickey uses Valspar coatings exclusively on all of its new and reconditioned transportation equipment for expertise that really shines.

- Robust color library with exact color match capability
- Excellent Decal Adhesion for flawless finishes
- High quality coatings to withstand harsh road conditions
- Durable protection to withstand daily use obstacles
- Sustainability focused innovation for maximum performance with minimal impact

OPERATION & MAINTENANCE - WIRING

Mickey Truck Bodies routes the electrical wiring "internally," using a system ground, through its bodies and trailers. It is not exposed to weather, road abuse, product, equipment or other elements that could cause damage. However, the wiring is readily accessible for routine maintenance, repair or replacement.

Our wiring complies with all DOT 108 regulations.

MAINTENANCE

Mickey uses a modular harness system to protect the wiring in its bodies and trailers. There is a main, front and rear harness that can be easily unplugged and connected to a test lead to help locate, identify and analyze any electrical problems. The harness system runs on top of the "A" frame in both bodies and trailers. For testing, there is a "quick disconnect" main plug which connects the rear and main harnesses that can be used to check the main power supply from the tractor or the chassis. (See Figure 8 for bodies; Figure 9 for trailers.)

All plug adapters are molded weather-proof connectors. We use sealed modular lights for safety and durability.

Conspicuity tape is required on all trailers, and must cover at least 50% of the length of the trailer. It cannot be higher than 50 inches or lower than 15 inches. Mickey bodies and trailers fully comply with these requirements.

The Mickey main rub rails are designed to receive standard width conspicuity tape, which is available from Mickey Truck Bodies Parts Department. The tape must be inspected routinely and replaced as necessary.

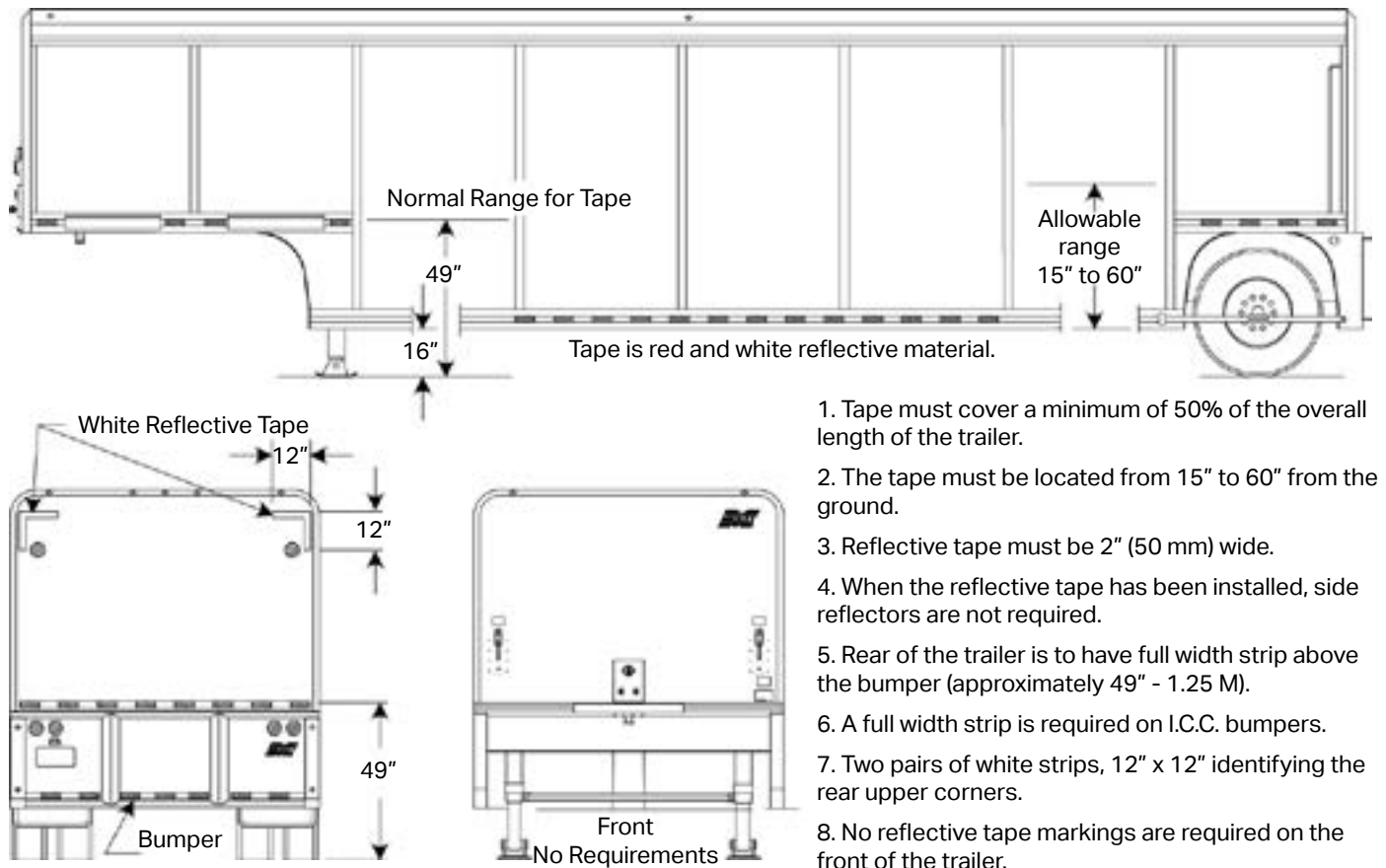

OPERATION & MAINTENANCE - RUNNING GEAR & SUSPENSION

Upper Coupler (King Pin Plate)

MAINTENANCE:

The Upper Coupler must be disconnected from the tractor, steam-cleaned and visually inspected every 30 days for cracks and wear. It must be lubricated — preferably with a lithium-based grease — and reconnected.

Various "slick" plates — or permanently-lubricated plates — are available, and work well. However, the unit must still be disconnected and inspected for wear, and the 5th wheel "jaws" lubricated.

Check the adjustment of the 5th wheel "jaws" regularly for proper closure to protect against accelerated and excessive king pin wear. Follow OEM specifications.

Landing Gear

MAINTENANCE

Landing Gear must be completely cycled, under load, on a weekly basis to avoid rust and maintain proper operation. It must also be lubricated through the zerk fittings, which are provided. Inspect for damage, and check the mounting bolts for tightness.

Suspension

MAINTENANCE Axle alignment must be checked every 30 to 60 days because improper alignment will cause excessive tire wear. Your Mickey Trailer is delivered pre-inspected for axle alignment and is covered for 90 days. The U-bolts should be re-torqued — the torque requirements are on a decal located on the front of your Mickey trailer bulkhead. U-Bolt nuts should be tightened with a properly calibrated torque wrench to 275 to 300 foot pounds of torque.

Prior to alignment, make certain the suspension is free and loose and has not been placed in a bind due to sharp turns or unusual maneuvers. Alignment can be accomplished manually in the following manner: Measure the distance from the king pin to the center line of the spindles on the front axle. (It is recommended that spindle extensions be used.) As noted in the sketch below, dimensions D and D₁ must be equal. Alignment can be accomplished

by loosening the torque arm clamp screws on both ends of the adjustable torque arm and turning the adjustment screw. After alignment has been accomplished on the front axle, tighten the 1/2" torque arm clamp bolts 45 - 55 foot pounds of torque in order to lock the alignment on the front axle. *(Continued on next page)*

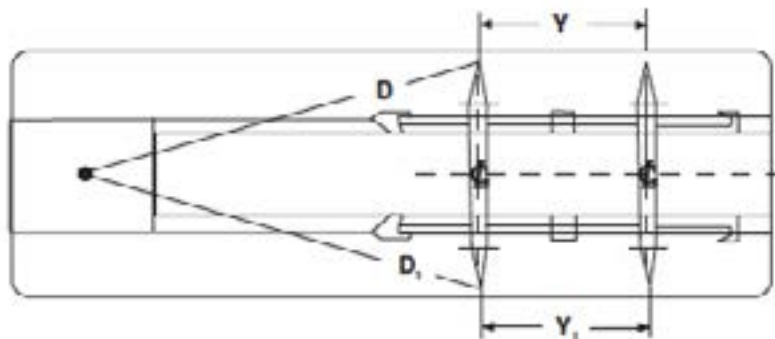

OPERATION & MAINTENANCE - RUNNING GEAR & SUSPENSION

(Continued from previous page) Next, align any succeeding axles with the front axle by following the same procedure of loosening the torque arm clamp bolts, turning the adjustment screw until dimensions Y and Y1 are equal, and then tightening the clamp bolts to the proper torque. After alignment has been completed on all axles, all 1/2" torque arm clamp bolts should be rechecked to make certain that they are tightened to the necessary 45 - 55 foot pounds of torque.

- Check the spring for broken or loose leaves, and check hangers for attachment, loose or worn bushings in the radius rod area, or equalizer bushings in the case of tandem trailer configuration.
- Inspect the air lines for leaks or abrasions. Drain moisture from air tanks.
- Check brake adjustment and brake pad wear per OEM specifications.
- Check axle hub for oil leaks and bearing adjustment on a daily basis.

Air Springs

Air springs are an integral part of the suspension and need to be inspected regularly to help ensure optimal vehicle performance. Replacing Hendrickson air springs with anything other than genuine Hendrickson springs can alter the performance of the suspension, and can lead to problems with load equalization, suspension damage and poor ride quality.

MAINTENANCE:

- Make sure your suspensions are set to the proper ride height
- Always insist on genuine Hendrickson air springs when servicing your Hendrickson suspension

OPERATION

- Never operate your vehicle without air in the air springs
- Keep the air spring pistons free of dirt and debris
- Keep the areas around each air spring clear of other vehicle components or items that can contact the rubber air spring bellows

Genuine Hendrickson air springs are easily identified by the Hendrickson name and logo on each air spring bellows.

**HENDRICKSON**

OPERATION & MAINTENANCE - RUNNING GEAR & SUSPENSION

Suspension Tune-up

Properly functioning shock absorbers can help reduce the wear of more expensive suspension components and assist in the reduction of tire wear and vibration damage to the cab and chassis. During periodic visual inspections, look for:

MAINTENANCE:

- Damaged mounts and bushings
- Damaged dust covers or bodies
- Bent or dented shocks
- Improper installation such as washers installed backwards
- Oil leakage — shocks may have some normal oil misting around the seal area resulting from thermal expansion as the shock warms during operation. If a shock absorber is found to be actually leaking oil in streams, it should be replaced.



If damaged or worn, replace individual shocks — no need to replace shocks in pairs or sets.

Trailer Bushing

For increased durability and reduced maintenance, Hendrickson trailer suspensions and lift axles feature a single TRI-FUNCTIONAL® bushing at each pivot connection. Optimal performance of your suspension depends on genuine Hendrickson bushings, featuring:

- Specially formulated rubber compounds created to stand up to tough operating conditions
- Areas of solid rubber providing fore-aft resistance to help ensure proper alignment and suspension tracking
- Highly engineered rubber voids, shaped and positioned to provide a smooth ride and absorb damaging road forces



MAINTENANCE:

As a part of your routine maintenance, visually examine all trailer pivot connections by looking up at the bushing tube from under the trailer, specifically inspecting the voids and metal cores. If service is necessary, be sure to specify genuine Hendrickson TRI-FUNCTIONAL bushings to ensure optimal control of your horizontal, vertical and roll forces.

For additional information, download Hendrickson publications: Pivot Bushing Inspection Procedure (B106), Bushing Replacement Procedures (L427) and Bushing Tube Spacer Inspection/Replacement Procedure (L750) from www.hendrickson-intl.com.

There's only one way to ensure the suspension's original performance
— ask for Hendrickson genuine parts by name.

For more technical information, visit:

www.hendrickson-intl.com/literature/pdfs_tech_tips.asp



Designed to work. Built to last.

OPERATION & MAINTENANCE - SUSPENSION TROUBLE SHOOTING

PROBLEM:

Air spring related problems.

Possible Cause and Remedy

Insufficient air pressure to suspension. Build vehicle air pressure in excess of 65 P.S.I. Malfunctioning air pressure protection valve. Test the valve.

Air leak or damaged line. Locate and repair.

Air spring punctured or leaking. Replace with proper air spring. Then check for proper clearance around air spring, 1 3/4" minimum. Also check shock absorbers.

Tire, tire rim or brake component-rubbing air spring. Check inside to inside tire dimension. There must be 1 3/4" minimum clearance around air spring. If not it may be necessary to reinstall suspension. Use tire rim back spacers to provide more clearance.

Air brake chamber rubbing air cell. Relocate chamber or rotate clamp ring for more clearance.

Over-extension of air spring. Suspension riding too high. Re-adjust height control valve(s) to attain proper vehicle ride height. Shock absorbers and/or connections broken. Replace. Wrong length shock absorbers. Replace. Mislocation of upper shock bracket. Relocate. Air spring improperly installed. Reinstall with proper Installation Instructions.

"Temporary Operation" If air loss occurs in the air suspension system and after attempts to repair have failed to correct the problem, it is recommended that the Height Control Valve Linkage be disconnected and all air exhausted from the system. There is an internal rubber bumper built into the air spring, which makes it possible to operate the vehicle cautiously at a reduced speed to the nearest place of repair. CAUTION: DO NOT OVERLOAD AXLES.

Front pivot or axle bushings worn prematurely.

Alignment bushing(s) not welded or worn. (Front Pivot) Weld per installation instructions. If worn, replace and realign axles.

Front pivot bolt loose. Connection not properly tightened.

Excessive lateral axle walk. (3-1/4" is maximum) Axle connection Pivot. Bolts loose properly tightened. Axle adapter welds failed. Remove old welds and reweld. Front pivot and/or axle connection bushings worn - Replace with proper SRK.

OPERATION & MAINTENANCE - SUSPENSION TROUBLE SHOOTING

PROBLEM:

Repeated shock absorber failures.

Possible Cause and Remedy

Over-extending shock absorbers. Suspension set at improper ride height. Re-adjust height control valve(s). Suspension mounted at wrong ride height. Wrong length or improper replacement shock absorber(s). Mislocation of upper shock bracket. Relocate. Refer to Installation Instructions.

Axle misaligned.

Alignment bushings not welded or out of alignment. Realign and weld to specifications.

Pivot or Axle bushings worn. Replace with proper Service Repair Kit (SRK) and torque to proper specifications.

Axle off tracking.

Alignment bushing(s) not welded or worn. If worn, replace. If not welded properly, weld alignment bushing(s) after axle is aligned.

Axle misaligned. Align axle by removing weld from alignment bushing, loosen pivot connection, shift axle, torque pivot nut

Loose or worn bushings at pivot or axle connection. If loose, tighten connection. Then check axle alignment and realign if necessary, if worn replace with proper SRK.

Worn bushing tube ends and/or face of washers worn at axle connections. Contact Hendrickson Service Department.

Suspension not properly installed. Check suspension installation, correct where necessary.

Frame twisted. Repair frame. Axle bent. Repair axle.

PINTLE HOOKS (DOUBLE CONFIGURATION)

MAINTENANCE:

- Check the attachment of the hook and attachment framework for obvious cracks and abnormal wear.
- Check air fittings for leaks.
- Check pintle hook for signs of wear and the latch for positive latching.

WARNING
DO NOT OPERATE TRAILERS
IN COMBINATION WHEN
LEAD TRAILER IS EMPTY AND
SECOND TRAILER IS LOADED

NOTICE

**SAFETY CHAINS MUST BE CONNECTED
AS SHOWN TO COMPLY WITH FEDERAL
MOTOR CARRIER SAFETY REGULATION
393.70, SUBPART F.**

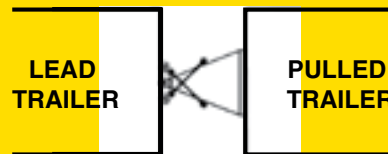



Designed to work. Built to last.

PARTS

PARTS - STANDARD MICKEY BODY PARTS

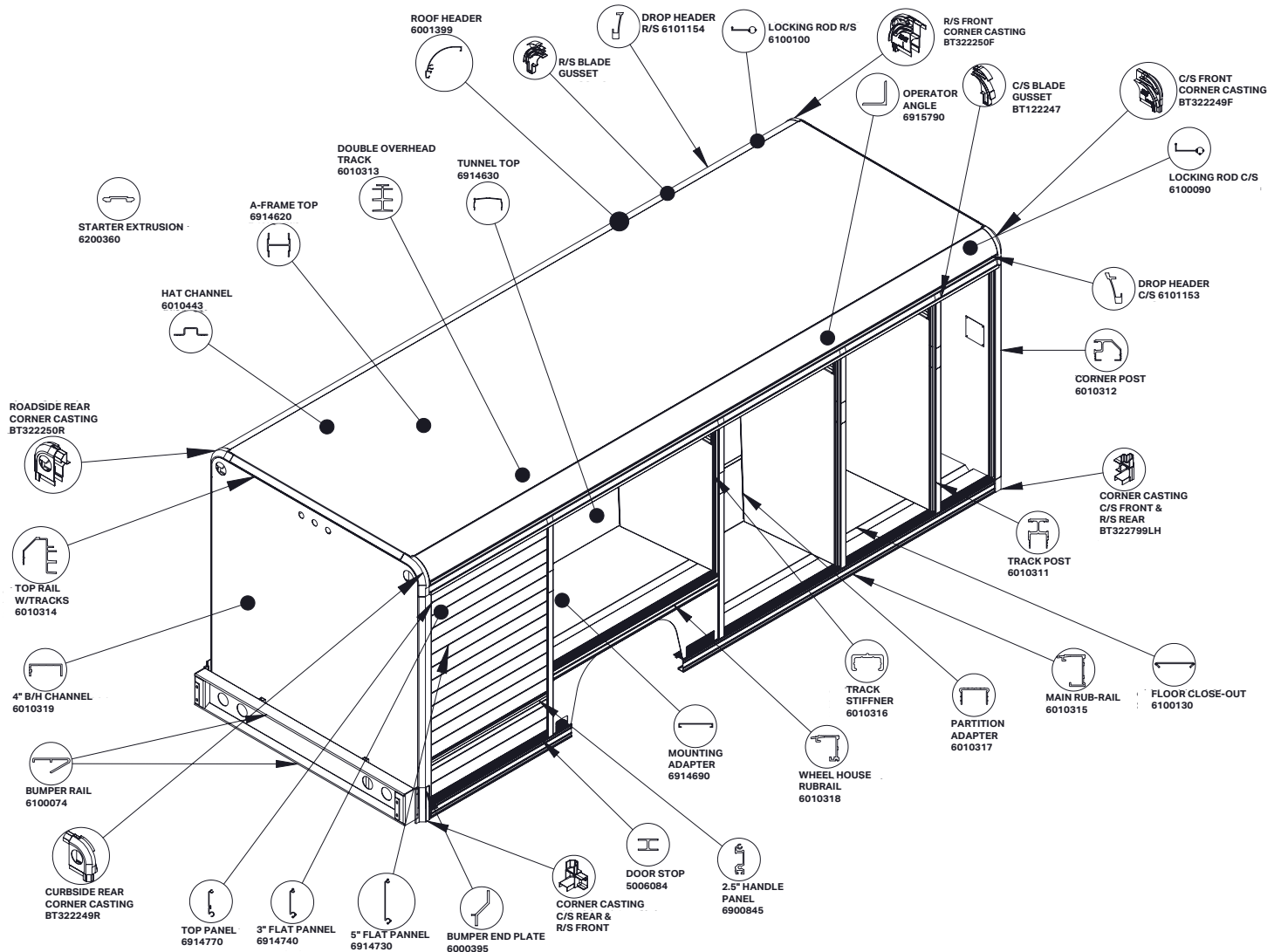

PARTS - STANDARD MICKEY TRAILER PARTS

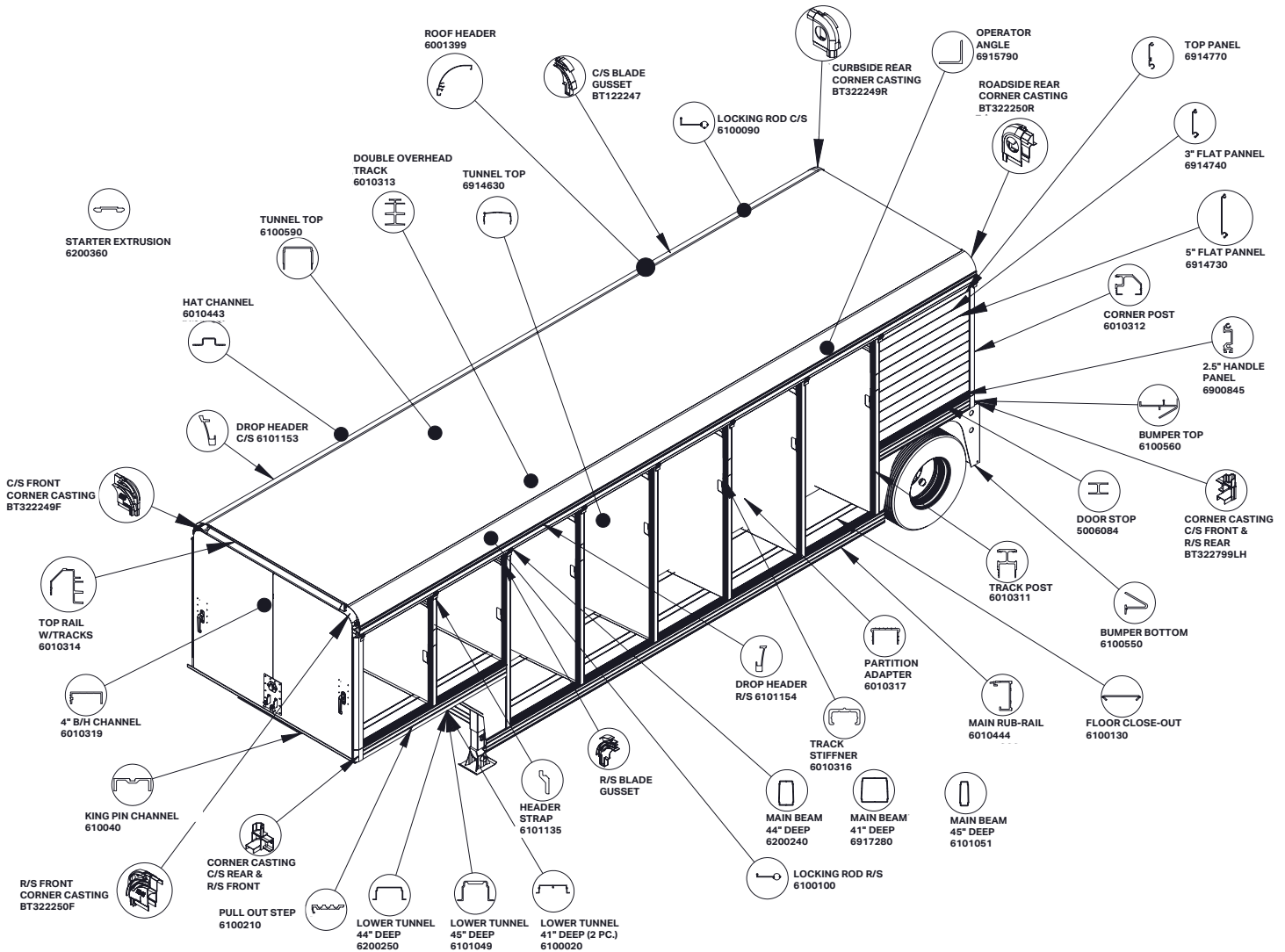



Designed to work. Built to last.

PARTS - DOOR COMPONENTS

Part #	Part Description
ROLL-UP DOORS (not pictured)	
4950012	88" tall - 40" wide 88" COMPLETE DOOR 40"
4950016	88" tall - 52" wide 88" COMPLETE DOOR 52"
4951587	57" tall - 40" wide 57" COMPLETE DOOR 40"
4951591	57" tall - 52" wide 57" COMPLETE DOOR 52"
4951592	57" tall - 57" wide 57" COMPLETE DOOR 57"
4951593	57" tall - 66" wide 57" COMPLETE DOOR 66"
4950005	82" tall - 40" wide 82" COMPLETE DOOR 40"
6800230	Beverage Door Cable - 114" DOOR CABLE ASSEMBLY 114"
6900160	24" Door Strap (Mickey) / (31" AMB) DOOR STRAP CLOTH 24" PULL W/GROMMETS
4916171	88" long Door Track Post w/Take Out 88" TRACK POST WITH TAKE OUT
6000366	External Track Protector LEXAN PROTECTIVE SNAP ON STRIPS 86"HM
6100293	Door Roller 1 1/4" DOOR ROLLER 1 1/4" SHAFT
5300167	2015 door mount for door cable assembly
4-512ES	2015 3-sided track insert 6104737 82.5" 6104738 56.5" 6104735 81.5" 6104740 120.5"
6009162	Liqui Fix Multi-purpose LIQUIFIX 16 OZ SPRAY BOTTLE (LUBE)

Our Door to Your Door

Let Mickey pre-build your roll-up door, including straps, locks, rollers and rubber weather seal (bottom). We'll paint it and ship it direct to you. Ready to roll!



6800230



6012355



6000366



4916171



6100293



6009162



3-sided track insert

PARTS - DOOR COMPONENTS

DOOR OPERATORS

- 6700100 30" operator
OPERATOR DOOR 30" x 20" DRUM.120 WIRE
- 6800860 37"operator (not pictured)
OPERATOR DOOR 37.5"X30X.120 FLAT W/CABLE
- 5002440 41.625" operator (not pictured)
OPERATOR DOOR TYPE C X41.625"
- 6101317 55.625" operator (not pictured)
OPERATOR 55 5/8" X 120
- 6007106 69" operator (not pictured)
DOOR OPERATOR 69.25X55X120 FLAT ENDS
- 6010190 72.625" operator (not pictured)
Operator x 72.625"



LOCKING HANDLES

- 6000797 Lock Cylinder w/key
CYLINDER LOCK WITH KEY FOR 111C #1250
- 6100965 Key Lock Driver Side (not pictured)
KEY LOCK HANDLE ASSEMBLY LH7011-L-WFMR-L
- 6101761 Key Lock Passenger Side (not pictured)
KEY LOCK HANDLE ASSEMBLY RH 7011-L-WFM-R
- 6101763 Pad Lock Driver Side
PAD LOCK HANDLE ASSEMBLY LH 7011-B-WFM-L
- 6101762 Pad Lock Passenger Side (not pictured)
PAD LOCK HANDLE ASSEMBLY RH 7011-B-WFM-R



PARTS - BUMPERS & RACKS

BUMPERS & RACKS

- 4916028 Mickey Rear Hand Truck Rack Assembly
ASSEMBLY, ADJ HAND TRUCK RACK, BEVERAGE
- 4916083 Front Hand Truck Rack
FRT BUMPER HTR ADJ W/Swing Arm STD
- 4955460 Mickey Route Buddy Rack
T-ROUTE BUDDY FOLDING HAND TRUCK RACK
- 4956207 Propane Tank Cart (not pictured)
B-Cart Holder Rear BulkHead(Amerigas)
- 4956248 Mickey Route Buddy Cart
Route Buddy 6-Wheel (Folding Handle) Cart
- 4916220 Hand Truck Swing Arm
SLAM BAR ASS'Y - PANELOC SLAM LATCH HTR
- 6008640 Spring Bolt Latch (not pictured)
SPRING BOLT LATCH (HTR LOCK PIN) OBS
- 4950060 30" x 96" wide bumper (not pictured)
BUMPER AT REAR COMPLETE 96" WIDE
- 4951288 16" x 96" wide bumper (not pictured)
AO REAR BULKHEAD - W/NEW CASTINGS
- 6900770 4 Hole Bumper Pad Rubber (not pictured)
DOCK BUMPER RUBBER 4-Hole Bev Style
- 6004996 12" Tall Vertical Dock Bumper
Rubber Dock Bumper Pad 3"x12"
- 6009008 24" Tall Vertical Dock Bumper
Rubber Bumper Pad 3"Wx24"H 2 HOLES



4916028



4916083



4955460



4916220



6004996



6009008



Designed to work. Built to last.

PARTS - SHELVING & STEPS

SHELVING & STEPS

4954145 Removable Shelf - 40" (not pictured)
SHELF REMOVABLE 40" BAY ALUM

4954155 Removable Shelf - 52"
SHELF REMOVABLE 52" BAY ALUM

5002680 Wheel Guard Step - 59"
WHEELGUARD ALUM 59in

5003850 Standard 24" Pull out Step
PULL OUT DECK STEP ALUMINUM 24" STD

5006273 30" Pull out Step (not pictured)
PULL OUT DECK STEP ALUMINUM 30"

5002710 Bolt on Wheelhouse Step Pin
WHEELGUARD STABILIZING PIN 40131

5002720 Wheel guard Lynch Ring
WHEELGUARD LYNCH RING F-108 40226

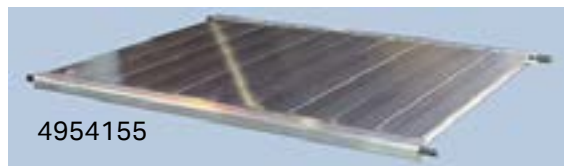

5002710



5002720

PARTS - SAFETY COMPONENTS

SAFETY COMPONENTS

- 6003279 Wheel Chocks
WHEEL CHOCK WC-1468
- 6000098 Mickey Safety Hand Grip
MICKEY SAFE GRIP (HAND HOLE LINER)
- 6006887 Cone holder (not pictured)
Safety Cone Holder Sparkletts
- 6011339 Anti Slip Grip Yellow strip on AmeriGas (not pictured)
ABRASIVE ANTI SLIP TAPE 60' ROLL YELLOW
- 6011285 Rear View Camera System
V-REAR VIEW CAMERA SYSTEM 1 RVS-082508
- 6104824 Wireless Camera System
B-CONVOY WIRELESS CAMERA SYSTEM BODY
- 6104825 Wireless Camera Backup (not pictured)
T-CONVOY WIRELESS CAMERA SYSTEM TRAILER
- 6001932 Registration Box (Document Holder) (Trucklight)
(not pictured)
DOCUMENT HOLDER (REGISTRATION BOX)
- 6000689 License Plate Lamp Kit (Truck-lite) (not pictured)
INCANDESCENT LICENSE LAMP & GRAY BRK KIT



6003279



6000098



6011285



6104824

PARTS - LANDING GEAR

LANDING GEAR

- 6900691 Landing Gear
LANDING GEAR BINKLEY LEGS 51000 (not pictured)
- 6800470 Landing Gear Crank Handle
LANDING GEAR CRANK HANDLE



6800470



Designed to work. Built to last.

PARTS -LIGHTING

LIGHTING

676767 Beverage Trailer /Body LED Light Kit (not pictured)

2015 LED Lighting



Tail Light 4"
#6009021



Round Clear LED 4"
#6009548



Round Amber
LED Marker 2.5"
#6008342



Round Red
LED Marker 2"
#6008342



ABS LED
Light 2"
#6100006

PARTS - MISCELLANEOUS

MISCELLANEOUS

6100608 Black BayBack Liner Kit (not pictured)
BAYLINER .062 X 48 X 87

6711280 Mickey Mudflap
MUD FLAPS MICKEY 12 x 24 #539OBS



6711280



Designed to work. Built to last.

OPTIONS

OPTIONS

Mini Side Load Bodies



4 Bay

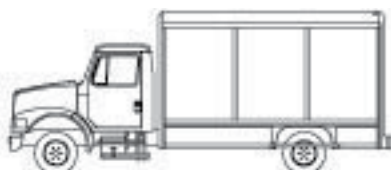

6 Bay low profile

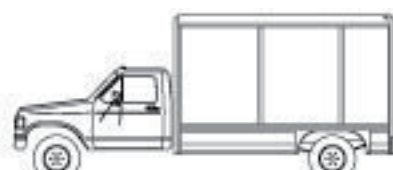

6 Bay



8 Bay & 8 Bay S-Floor

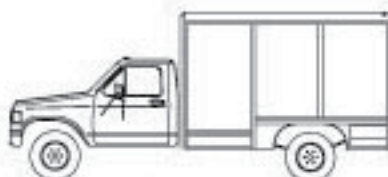

6 Bay /extra capacity



Mickey Genuine Parts: The Choice For Quality

We offer a large inventory of stock parts for same-day shipping on all orders received by 2 PM Eastern Time, and all fabricated parts are shipped within one to three working days.

Mickey carries stock parts for all of its units, even other makes and models.

Rocky Barham, Mickey Parts Manager
rbarham@mickeybody.com

OPTIONS

Standard Side Load Bodies

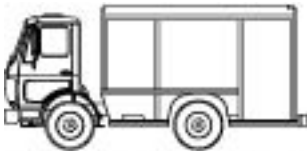

6 Bay straight frame
Tilt cab conversion

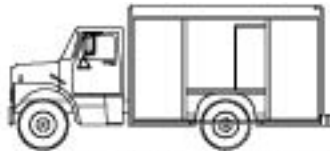

6 1/2 Bay drop frame

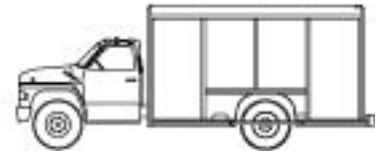

8 Bay drop frame



8 1/2 Bay drop frame
Tilt cab conversion



8 1/2 Bay drop frame

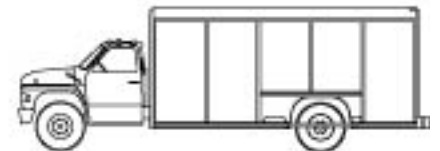

10 Bay drop frame



10 1/2 Bay drop frame
Tilt cab conversion

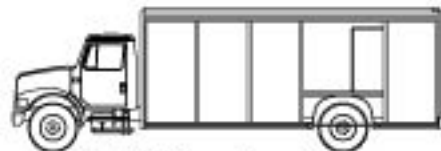

10 1/2 Bay drop frame

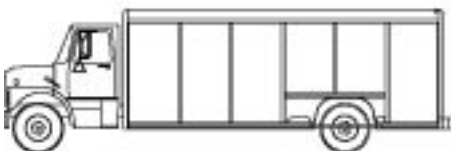

12 Bay drop frame

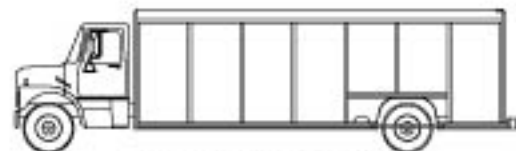

14 Bay drop frame

OPTIONS

Conventional Side Load Trailers

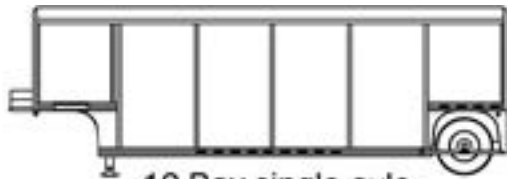

12 Bay single axle
Extended king pin

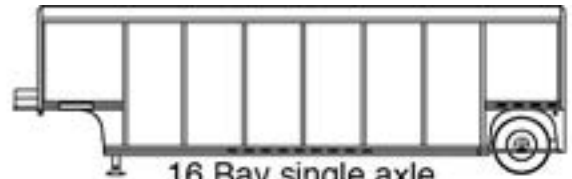

16 Bay single axle
Extended king pin

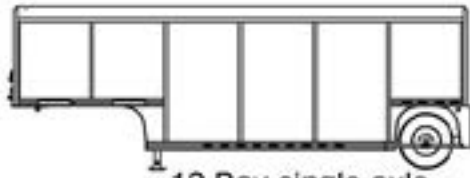

12 Bay single axle

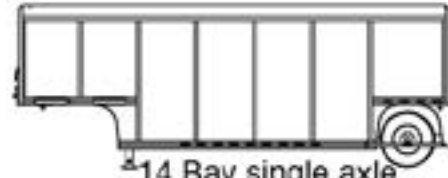

14 Bay single axle

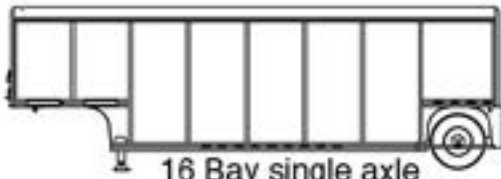

16 Bay single axle

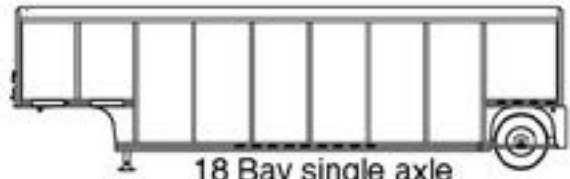

18 Bay single axle



16 Bay
(4 bays accessible from rear)

OPTIONS

Bulk Side Load Bodies

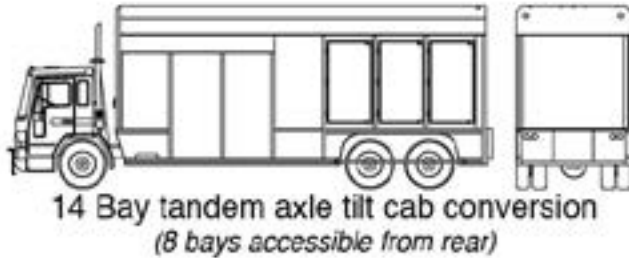
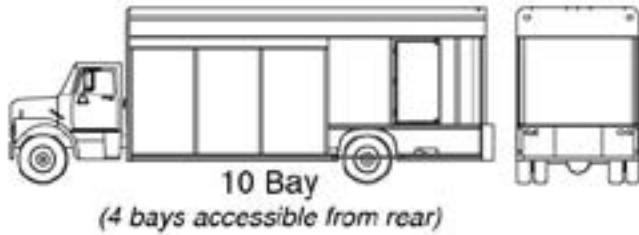

Bulk Side Load Trailers

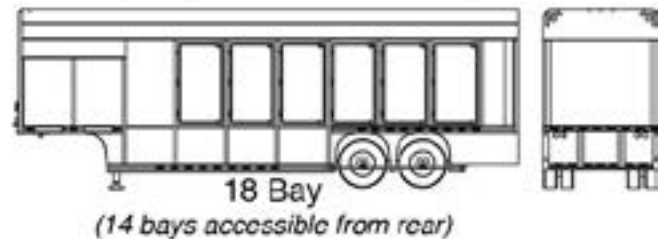
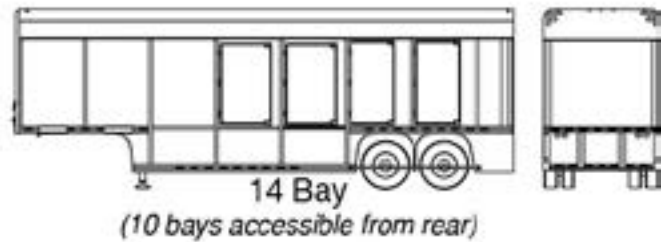
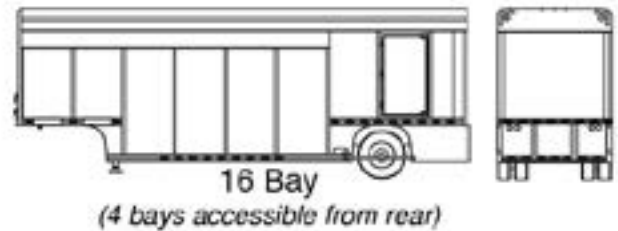

Side and or rear loading bulk delivery with single rear door.
Not all bay configurations are shown.



Designed to work. Built to last.

OPTIONS

Water Bodies

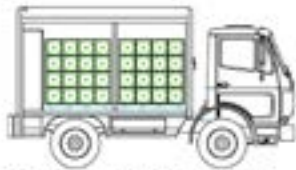

4 Bay Mini 4x4 Rack

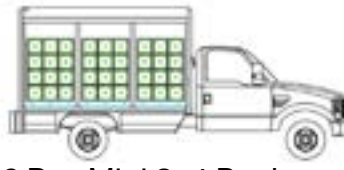

6 Bay Mini 3x4 Rack



6.5 Bay Mini 4x5 Rack

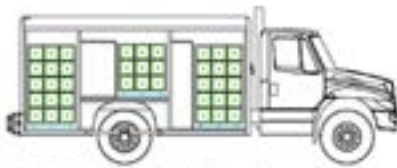

6.5 Bay Mini 3x5 Rack



8.5 Bay Mini 3.5 Rack

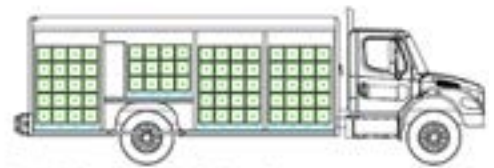

8.5 Bay Mini 4x5 Rack



10.5 Bay Mini 3x5 Rack

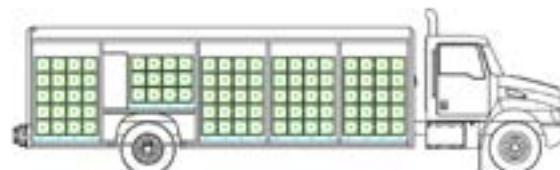

10.5 Bay Mini 4x5 Rack

Note: Payload Bottles and Weight may vary depending on product, packing material and loading. Chassis data may vary depending on manufacturer. GVRW = Est. Payload + Body Weight + Chassis Weight + Driver + Fuel. Standard door openings are 76"/51"; other door opening options are available. These examples are only a small representation of Mickey's custom-designed capabilities. Please contact us with your specs for a CAD drawing and quote.

BODY SPECIFICATIONS					PAYLOAD (EST.)		CHASSIS (EST.)
Bottles	Style/Model	Door	Length	Weight	Bottles	Weight	GVWR
72	4-Bay Mini/040 ST 65	40W	134	1,900	72	3,600	19,500
96	4-Bay Mini/040 ST 65	52W	134	1,900	96	4,800	19,500
108	6-Bay Mini/060 ST 65	40W	136	1,900	108	5,400	19,500
144	6-Bay Mini/060 ST 65	52W	172	2,450	144	7,200	19,500
156	6.5 D/065 DC 76	40W	164	2,360	156	7,800	26,000
156	6.5 D/065 DC 76C	40/57W	172	2,550	156	7,800	26,000
208	6.5 D/065 DC 76	52W	188	2,660	208	10,400	26,000
216	8.5 D/085 DC 76	40W	202	2,950	216	10,800	26,000
216	8.5 D/085 DC 76C	40/57W	224	3,200	216	10,800	26,000
288	8.5 D/085 DC 76	52W	238	3,500	288	14,400	26,000
276	10.5 D/105 DC 76	40W	245	3,600	276	13,800	33,000
276	10.5 D/105 DC 76C	40/57W	266	3,850	276	13,800	33,000
368	10.5 D/105 DC 76	52W	297	4,300	368	18,400	33,000

OPTIONS

ProVend™ Series Vending Bodies

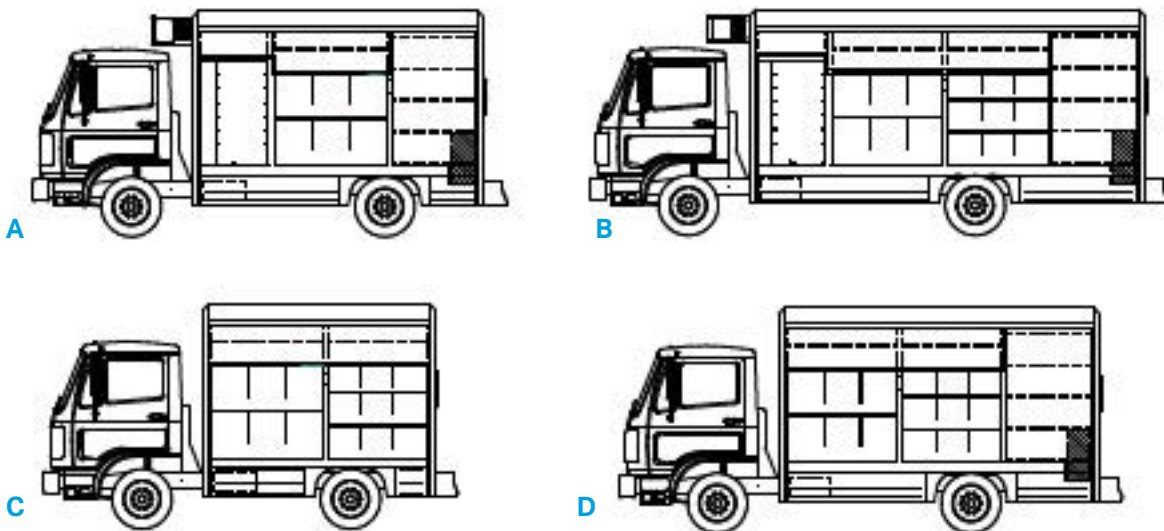

STANDARD PROVEND II SPECIFICATIONS			
Body Model #	Body Length	C/A*	Dimensions
A) PV/4Bay	152"	105.95"	35/59/44
B) PV/6Bay	206.5"	141.38"	35/59/52/44
C) PV/4Bay	121"	85.80"	59/52
D) PV/6Bay	167.5"	116.03"	59/52/44

Door Dimensions

- 20 oz. bottles - aluminum roll-up side doors 59"w x 46"h; capacity 48 cases/bay set
- 12 oz. cans - aluminum roll-up side doors 52"w x 46"h; capacity 96 cases/bay set
- Roll-up rear door - 42"w x 78"h, spring-loaded counter balances; extruded door tracks

Drink Racks

- Cola bays for 20oz bottles: 59"w x 23"d with 1 adjustable shelf per bay
- Cola bays for 12oz cans: 52"w x 23"d with 2 adjustable shelves per bay
- Vertical adjustable dividers for all cola bays, 2 per shelf
- 4 "Quick Release" vertical retaining bars per cola bay



Interior walk-in,
aluminum non-skid floor



Easy step-in
rear access



Stand-up refrigeration
with cold plate cooling



Interior walk-in with
composite floor

OPTIONS

Full-Service Vending Body



- Full-Width Insulated Refrigerated Compartment with Cold Plate Technology
- 8-Cubic-Foot Freezer Cart
- Black Synthetic Anti-Skid Floor
- 44" Aluminum Roll-Up Rear Door
- (2) 10-Bay Cola Racks
- (3) LED Dome Lights & LED Marker Lights
- Adjustable Aluminum Shelving
- Double Door Safe
- Full Width Galvanized Step Bumper



Coldplate Vending Cart installed.

Coldplate Vending Carts

- Durable Stainless Steel Top & Corners
- Stainless Steel Handle Serves as Locking Bar to Secure Cart Lids
- Coldplate Technology Keeps Product Frozen throughout the Day
- Storage Compartment for Power Cord
- Oversized Lids for Easy Access and Dispensing
- Walls are over 3"/7.6 cm thick with Foam Insulation for Maximum Hold Over Time
- Removable Bottom Drain Plug for Easy Cleaning
- Ozone-Friendly CFC Free R404A Refrigerant
- 24/7 Customer Care Department

OPTIONS - ELECTRIC DOOR LOCKING SYSTEM - E-LOCK



Break-ins, frozen locks and lost keys all cost your company money and time, and leave a black mark on your customer service record.

Eliminate all three problems with the Mickey E-Lock system!

Mickey's new keyless, roll-up door locking system is controlled by a pair of switches mounted within easy reach of the driver's seat.

- Curbside, roadside doors lock/unlock separately
- No broken handles
- Failsafe mechanism keeps doors from locking when door is open, which protects paint and decals
- Manual bypass system activates in case of power failure
- Indicator lights on the dashboard illuminate when the doors are unlocked

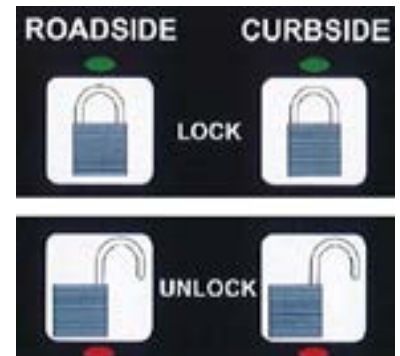

**NO VISIBLE LOCKING DEVICE
ON THE OUTSIDE OF THE UNIT!**



Designed to work. Built to last.

Mickey Reconditioning & Service Centers

No Surprises

We handle every reconditioning and repair job separately and uniquely according to the specific needs of the customer. All labor and parts costs are outlined in Work Estimates that must be approved in advance by the customer. If other needs or recommendations occur during the reconditioning or repair process, the customer will be notified in advance, in writing, and must approve all extended work and additional costs.

Used Equipment

Mickey stocks a wide assortment of road-ready bodies and trailers that have been completely reconditioned. We also pay competitive rates for quality used vehicles. Visit our web site at www.mickeyparts.com. While we don't keep all of our used equipment inventory on this site we do maintain representative samples. In many cases this site may list just one of many similar units we have in stock.

Browse our on-line inventory and then give one of our sales representatives a call at 1-800-334-9061. Ask for Used Truck Sales or dial extension 3257. Our inventory listings are split by class to allow you to focus on your needs and



Mickey operates the only nationwide network of full-service Reconditioning & Service Centers in the truck body and trailer manufacturing business.

Mickey Reconditioning/Service Centers

Mid-Atlantic
Thomasville, North Carolina
Phone: 800-334-9061

Northeast
Farmingdale, New Jersey
Phone: 800-938-5181

Southeast
Ocala, Florida
Phone: 800-276-5891

Midwest
Bloomington, Illinois
Phone: 800-791-6965

Mickey Authorized Reconditioning/Service Centers

Mini Coach Inc.
Bell, CA
323-773-5775

Transportation Services
Sacramento, CA
916-737-5750

Dallas Trailer Repair
Irving, TX
972-579-9027



Designed to work. Built to last.

ORDERING REPLACEMENT & OPTIONAL PARTS

Mickey Genuine Parts: The Choice For Quality

The Mickey Parts Shop offers a large inventory of stock parts for same-day shipping on all orders received by 2PM EST, and all fabricated parts are shipped within one to three working days. The inventory covers all Mickey products and many competitive makes and models, and includes lift gates, structural parts, lighting and more.

**Be sure to use Mickey Genuine Parts when repairing your Mickey equipment.
Imitation parts don't compare in quality, consistency or reliability.**

To get the parts when you need them and where you want them, Mickey offers 4 easy-ordering options:

1. A complete list of available stock and fabricated parts, as well as quality used equipment, is available at The Mickey Parts Shop eCommerce web site, designed for easy on-line shopping, ordering and delivery options. Visit www.mickeyparts.com

2. Connect with Mickey Parts wherever you are with our mobile apps from the Apple Store or Google Play (Android). Use these Apps to:

- a. Browse and purchase products right from your mobile device
- b. Messages from Mickey Parts
- c. Contact info
- d. A live feed of our social channels
- e. Information about us



3. All parts are available through Mickey's main manufacturing facility in High Point, NC and also through its 4 full-service Reconditioning/Service Centers:

Mid-Atlantic	Northeast	Southeast	Midwest
Thomasville, NC	Freehold, NJ	Ocala, FL	Bloomington, IL
336-888-2256	800-938-5181	800-276-5891	800-791-6965

4. Call or email Mickey Parts Manager at 333-888-2234 or parts@mickeybody.com.



Designed to work. Built to last.

MICKEY TRUCK BODIES INC
1305 Trinity Ave., High Point, NC 27261
TEL: 800-334-9061
www.mickeybody.com
www.mickeyparts.com